

XLR Adaptor Kit
XLR-K3M



Use this Help Guide when you have issues or questions on how to use your XLR adaptor kit.

[Supported camera models](#)

[Identifying the parts](#)

Preparations

[Unpacking](#)

[Attaching/removing the XLR adaptor to/from the camera](#)

[Attaching/removing the supplied microphone](#)

Recording

[Selecting the digital or analog input type](#)

[Using the supplied microphone](#)

[Using a device, such as an external audio device](#)

[Minimizing noise with the LOW CUT function](#)

[Adjusting the recording volume level](#)

[Selecting the audio input for recording audio to the channels on the camera](#)

About this unit

[Notes on use](#)

[Specifications](#)

[Trademarks](#)

5-008-246-12(1) Copyright 2019 Sony Corporation

XLR Adaptor Kit
XLR-K3M

Supported camera models

This unit is a kit that includes an XLR adaptor for cameras with the Multi Interface Shoe in addition to a microphone. For camera models compatible with this unit, visit the website at:
<https://www.sony.net/dics/k3m/>

Identifying the parts

Body parts

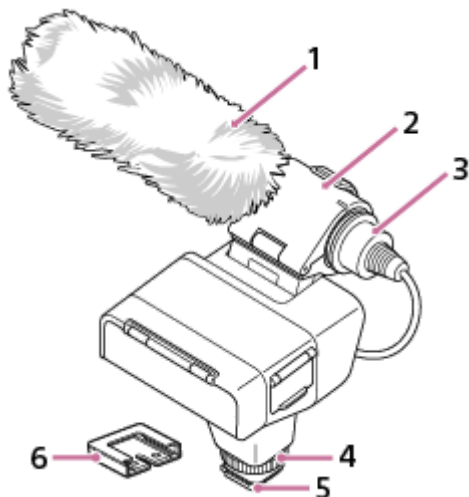

1. Wind screen
2. Microphone holder
3. Microphone
4. Lock dial
5. Multi Interface foot

Note

- Do not touch the connector of the Multi Interface foot with bare hands.

6. Connector protect cap

Switches and dials

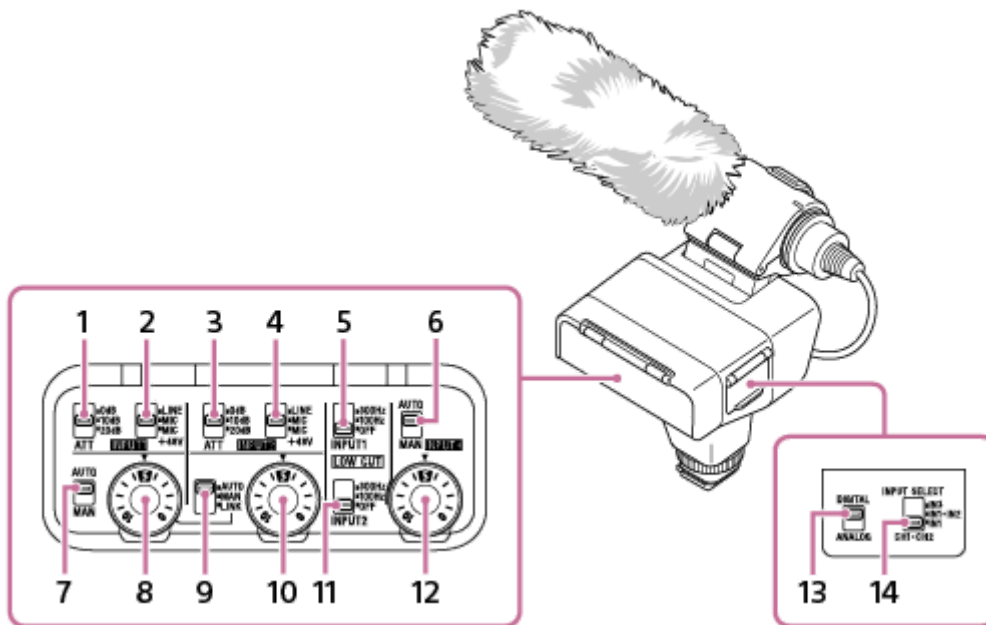

1. ATT (INPUT1) switch
Select the standard input level of the INPUT1 jack. This switch setting is active when the INPUT1 (LINE/MIC/MIC+48V) switch is set to "MIC" or "MIC+48V."
2. INPUT1 (LINE/MIC/MIC+48V) switch
Select the option suitable for the device connected to the INPUT1 jack.
3. ATT (INPUT2) switch
Select the standard input level of the INPUT2 jack. This switch setting is active when the INPUT2 (LINE/MIC/MIC+48V) switch is set to "MIC" or "MIC+48V."
4. INPUT2 (LINE/MIC/MIC+48V) switch
Select the option suitable for the device connected to the INPUT2 jack.
5. LOW CUT (INPUT1) switch
Use this switch to minimize unwanted noises by attenuating low-frequency components of the input audio from the INPUT1 jack.
6. AUTO/MAN (INPUT3) switch
Select the method (Auto/Manual) to adjust the volume level of the input audio from the INPUT3 jack.
7. AUTO/MAN (INPUT1) switch
Select the method (Auto/Manual) to adjust the volume level of the input audio from the INPUT1 jack.
8. AUDIO LEVEL (INPUT1) dial
Adjust the recording volume level of the input audio from the INPUT1 jack.
9. AUTO/MAN/LINK (INPUT2) switch
Select the method (Auto/Manual/Link to INPUT1) to adjust the volume level of the input audio from the INPUT2 jack.
10. AUDIO LEVEL (INPUT2) dial
Adjust the recording volume level of the input audio from the INPUT2 jack.
11. LOW CUT (INPUT2) switch
Use this switch to minimize unwanted noises by attenuating low-frequency components of the input audio from the INPUT2 jack.
12. AUDIO LEVEL (INPUT3) dial
Adjust the recording volume level of the input audio from the INPUT3 jack.
13. DIGITAL/ANALOG switch
Select the digital or analog input type.

If your camera is compatible with the digital audio interface of the Multi Interface Shoe, set the switch to “DIGITAL.” This allows the unit and the attached camera to communicate with each other with digital signals and provide audio recording with minimum noise insertion.

14. INPUT SELECT switch

Select the audio input for recording audio to the channels on the attached camera.

Ports and jacks

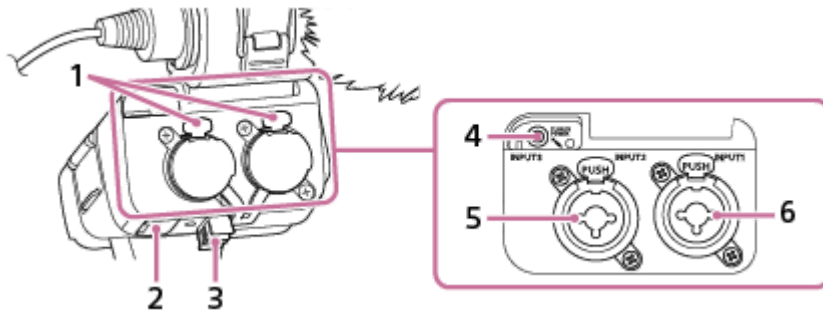

1. Release lever
2. Micro USB port
3. Cable holder
4. INPUT3 jack (Stereo mini-jack, plug-in-power compatible)
5. INPUT2 jack (3-pin XLR/TRS, female type, phantom-power compatible)
6. INPUT1 jack (3-pin XLR/TRS, female type, phantom-power compatible)

Related Topic

- [Supported camera models](#)
- [Attaching/removing the XLR adaptor to/from the camera](#)
- [Attaching/removing the supplied microphone](#)
- [Selecting the digital or analog input type](#)
- [Using the supplied microphone](#)
- [Using a device, such as an external audio device](#)
- [Minimizing noise with the LOW CUT function](#)
- [Adjusting the recording volume level](#)
- [Selecting the audio input for recording audio to the channels on the camera](#)

XLR Adaptor Kit
XLR-K3M

Unpacking

If you find anything missing, please contact your dealer.
The number in the parentheses indicates the quantity.

- XLR Adaptor (XLR-A3M) (1)
- Microphone (ECM-XM1) (1)
- Wind screen (1)
- Connector protect cap (attached) (2)
- Extension Cable for Audio (1)
- Case (1)
- Set of printed documentation

Attaching/removing the XLR adaptor to/from the camera

Attach the XLR adaptor to a camera.

Note

- Before attaching/removing the adaptor to/from a camera, turn off the power to the camera.

1 Remove the connector protect cap from the XLR adaptor.

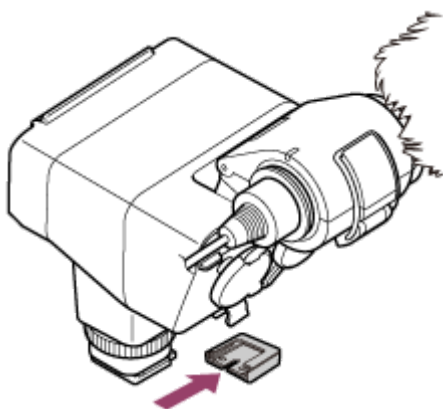

2 Slide the Multi Interface foot of the XLR adaptor into the shoe on the camera (①), and then rotate the lock dial in the "LOCK" direction (②) to firmly secure the adaptor.

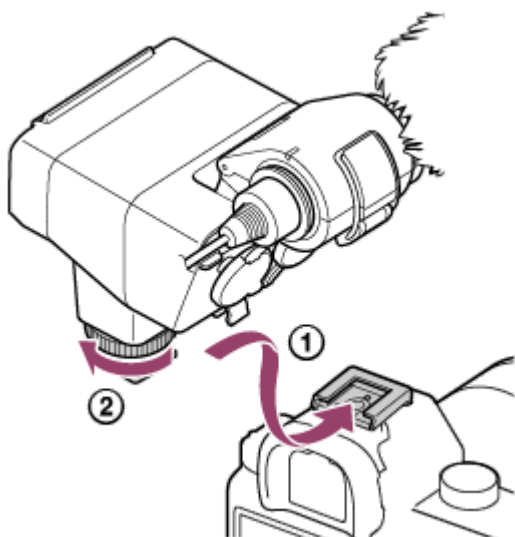

When it is difficult to insert the Multi Interface foot into the shoe, rotate the lock dial counterclockwise until it stops, and then try again.

To remove the XLR adaptor

Turn off the power to the camera, rotate the lock dial counterclockwise until it stops, and then slide out the Multi Interface foot from the shoe.

To use the Extension Cable for Audio for attachment

Alternatively, you can use the supplied Extension Cable for Audio to attach the XLR adaptor to the camera. Use of this cable for attachment comes in handy when you stand away from the camera and use the microphone attached to the XLR adaptor for recording.

Note

- Using the supplied Extension Cable for Audio with products other than XLR-K3M may affect its performance, leading to accidents or malfunction.

1. Remove the connector protect caps from the XLR adaptor and the Extension Cable for Audio.
2. Slide the Multi Interface foot of the XLR adaptor into the shoe of the Extension Cable for Audio (①), and then rotate the lock dial in the "LOCK" direction (②) to firmly secure the adaptor.

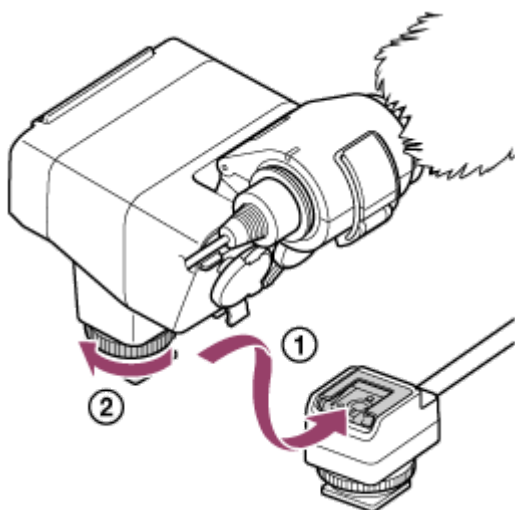

3. Slide the Multi Interface foot of the Extension Cable for Audio in to the shoe on the camera (③), and then rotate the lock dial in the "LOCK" direction (④) to firmly secure the cable.

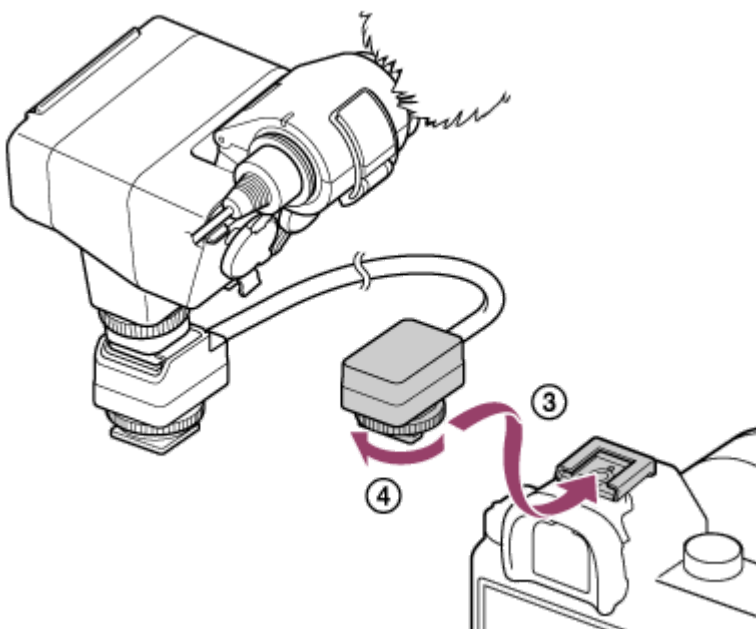

Attaching/removing the supplied microphone

Attach the supplied microphone (ECM-XM1) to the XLR adaptor.

Note

- Before attaching/removing the microphone to the adaptor, be sure to set the INPUT1 (LINE/MIC/MIC+48V) switch to the position other than "MIC+48V." While the switch is set to "MIC+48V," plugging/unplugging the cable from the microphone may cause a loud noise or a malfunction of the microphone.

- 1 Fit the supplied wind screen over the microphone.

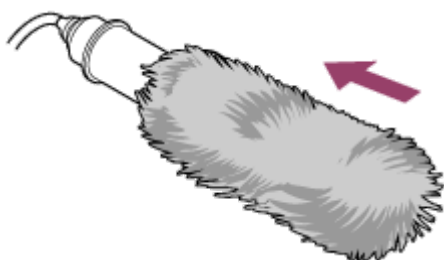

- 2 Unlock the microphone holder and open the lid of the holder.

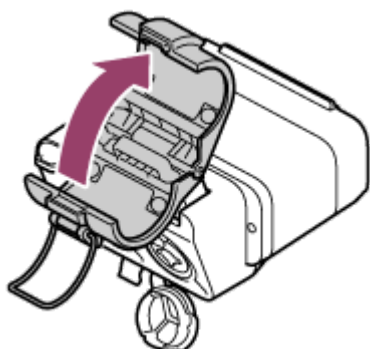

- 3 Place the microphone on the microphone holder so that the model name (ECM-XM1) inscribed on the microphone faces upward, close the lid of the holder, and then lock the holder.

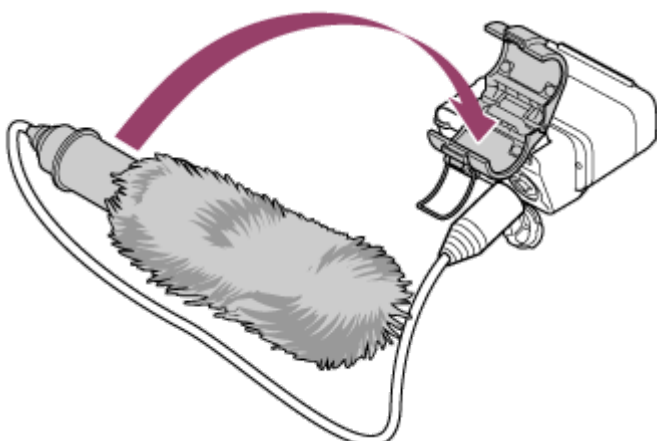

- 4 Connect the cable from the microphone to the INPUT1 jack on the XLR adaptor.

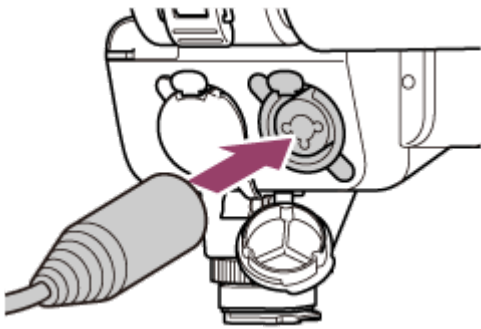

- 5 Tuck the cable from the microphone into the cable holder on the XLR adaptor.

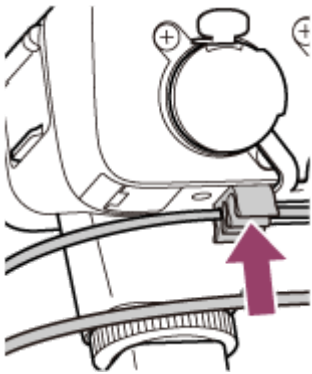

Do not tug the cable with excessive force or let the cable bend before you tuck it into the cable holder to avoid a possible significant tilt of the microphone attached to the microphone holder.
To achieve sufficient vibration isolation effect, be sure to avoid a significant tilt of the microphone.

- 6 Set the INPUT1 (LINE/MIC/MIC+48V) switch to “MIC+48V.”

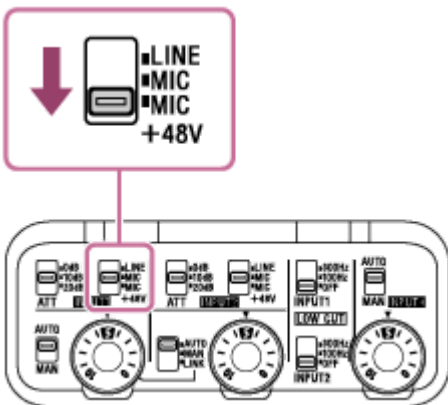

To remove the microphone

1. Set the INPUT1 (LINE/MIC/MIC+48V) switch to the position other than “MIC+48V.”
2. Press and hold the release lever, grasp the plug of the cable from the microphone, and pull out the cable.
3. Remove the microphone from the microphone holder.

Related Topic

- [Using the supplied microphone](#)



Selecting the digital or analog input type

Set the audio input type.

- 1 Change the DIGITAL/ANALOG switch setting to suit your camera.

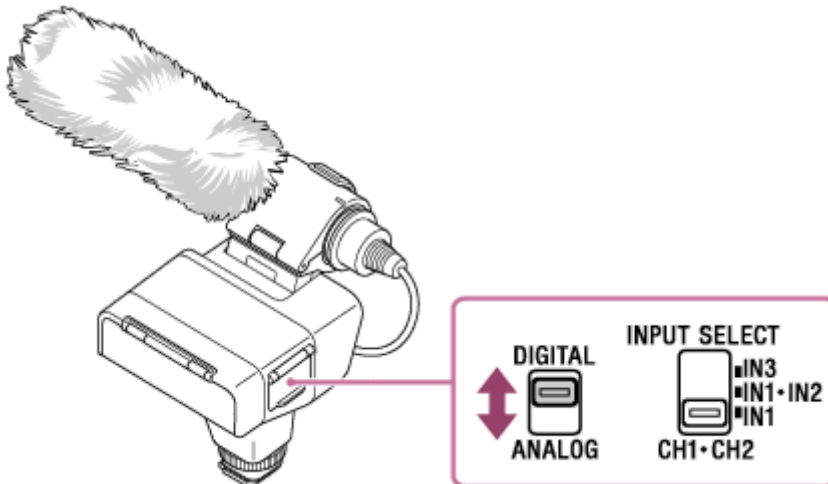

If your camera is compatible with the audio interface of the Multi Interface Shoe, set the switch to “DIGITAL.” This allows the unit and the attached camera to communicate with each other with digital signals and provide audio recording with minimum noise insertion.

Related Topic

- [Supported camera models](#)

XLR Adaptor Kit
XLR-K3M

Using the supplied microphone

Use the supplied microphone that you attached to the XLR adaptor following the instructions in [“Attaching/removing the supplied microphone”](#) for recording.

You can record super-directional monaural sound.

- 1 Make sure that the INPUT1 (LINE/MIC/MIC+48V) switch is set to “MIC+48V.”

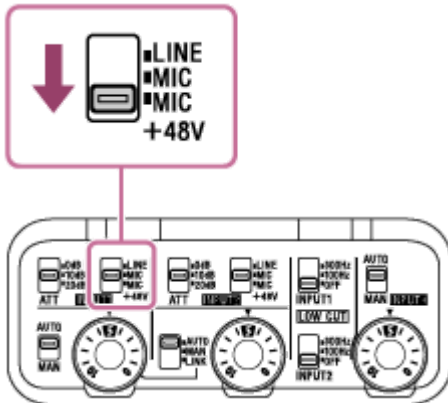

- 2 Set the ATT (INPUT1) switch to “10dB.” (Recommended)

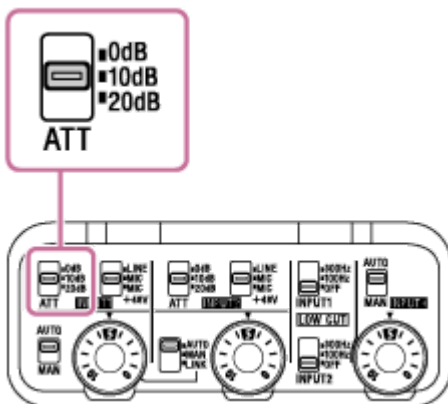

With the ATT switch, you can set the standard input level suitable for the sensitivity of the microphone connected to the XLR adaptor or for the volume level of the input audio. When using the supplied microphone, it is recommended that you set the switch to “10dB.”

To use a microphone other than the supplied one or an external device, see [“Using a device, such as an external audio device.”](#)

- 3 Set the INPUT SELECT switch to “IN1.”

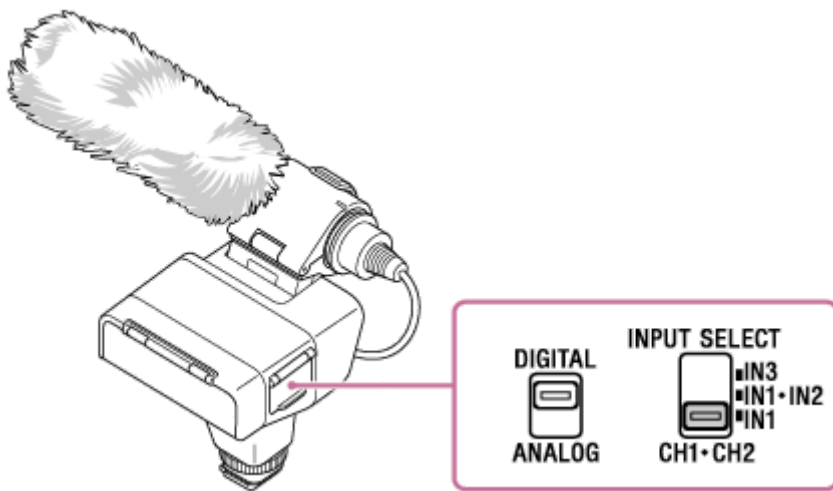

The audio from the microphone connected to the INPUT1 jack is recorded to both the CH1 and CH2 channels on the attached camera.

4 Adjust the recording volume level.

For detailed instructions on adjustment, see [“Adjusting the recording volume level.”](#)

5 Operate the camera to start recording.

For details, refer to the Help Guide provided for your camera.

Note

- Adjustment of the recording volume level on the attached camera does not work.

Related Topic

- [Selecting the digital or analog input type](#)
- [Minimizing noise with the LOW CUT function](#)
- [Selecting the audio input for recording audio to the channels on the camera](#)

Using a device, such as an external audio device

Use a microphone other than the supplied one or an external audio device, such as an audio mixer, for recording.

Note

- Before connecting/disconnecting a device to/from the INPUT1 or INPUT2 jack, be sure to set the INPUT1 (LINE/MIC/MIC+48V) or INPUT2 (LINE/MIC/MIC+48V) switch to the position other than "MIC+48V." While the switch is set to "MIC+48V," plugging/unplugging the cable from the device may cause a loud noise or a malfunction of the device.

1 Connect your desired device to the INPUT1, INPUT2, or INPUT3 jack on the XLR adaptor.

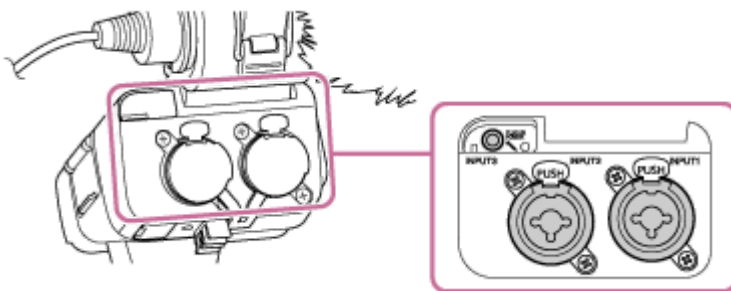

When using either the INPUT1 or INPUT2 jack, connect the device to the INPUT1 jack.
When connecting the device to the INPUT3 jack, proceed to step 3.

2 Select an input audio source.

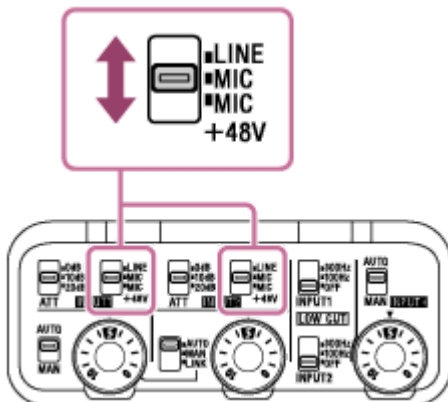

Depending on the device connected to the INPUT1 or INPUT2 jack, set the INPUT1 (LINE/MIC/MIC+48V) or INPUT2 (LINE/MIC/MIC+48V) switch as follows:

- LINE (Standard input level at +4 dBu (0 dBu = 0.775 Vrms)): An external audio device (e.g. an audio mixer)
- MIC: A dynamic microphone or a microphone with the built-in battery
- MIC+48V: A microphone compatible with +48V power (phantom power)

3 With the INPUT SELECT switch, select the audio input for recording audio to the channels on the attached camera.

Select the audio input jack on the unit (INPUT1, INPUT2, or INPUT3) through which audio is recorded to the channels on the camera.

For details, see [“Selecting the audio input for recording audio to the channels on the camera.”](#)

- 4 When the device is connected to the INPUT1 or INPUT2 jack, set the standard input level of the microphone.

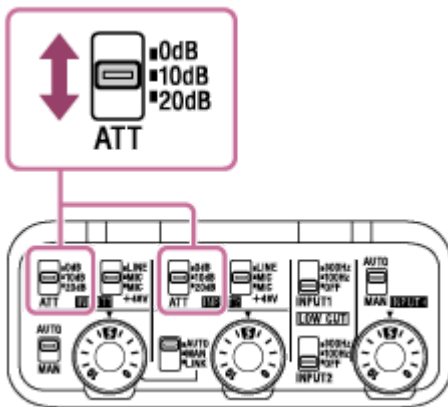

When the INPUT1 (LINE/MIC/MIC+48V) or INPUT2 (LINE/MIC/MIC+48V) switch is set to either “MIC” or “MIC+48V,” you can set the standard input level with the ATT (INPUT1) or ATT (INPUT2) switch. Select the level suitable for the sensitivity of the connected microphone or for the volume level of the input audio.

- 0dB: Standard input level at -60 dBu
Suitable for recording with a low-sensitivity microphone while amplifying sounds.
- 10dB: Standard input level at -50 dBu
Recommended input level for the supplied microphone.
- 20dB: Standard input level at -40 dBu
Suitable for recording with a high-sensitivity microphone while keeping the sound volume low.

- 5 Adjust the recording volume level.

For detailed instructions on adjustment, see [“Adjusting the recording volume level.”](#)

Note

- When the INPUT1 (LINE/MIC/MIC+48V) or INPUT2 (LINE/MIC/MIC+48V) switch is set to “LINE,” the standard input level is fixed at +4 dBu. The standard input level does not change depending on the ATT switch setting.

Hint

- If the noise from the jacks with no device connected is disturbing, set the INPUT1 (LINE/MIC/MIC+48V) or INPUT2 (LINE/MIC/MIC+48V) switch to “LINE.”

Related Topic

- [Selecting the digital or analog input type](#)
- [Minimizing noise with the LOW CUT function](#)

Minimizing noise with the LOW CUT function

Minimize unwanted noises, such as wind noise, air-conditioning noise, and vibration noise, by attenuating low-frequency components of the input audio from the INPUT1 or INPUT2 jack.

- 1 Change the LOW CUT (INPUT1) or LOW CUT (INPUT2) switch setting.

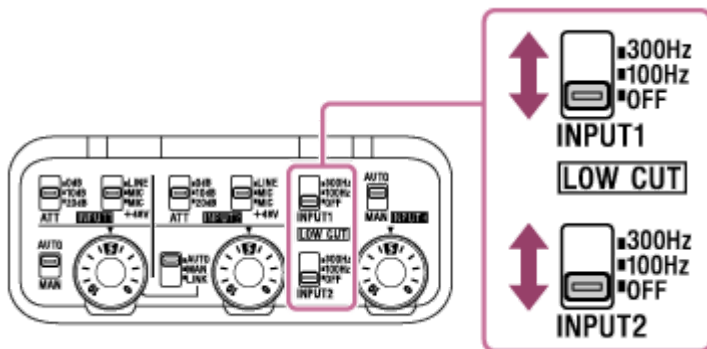

Select either “300Hz” or “100Hz” depending on the noise to minimize.

Related Topic

- [Using the supplied microphone](#)
- [Using a device, such as an external audio device](#)

Adjusting the recording volume level

Adjust the recording volume level of the input audio from the INPUT1, INPUT2, or INPUT3 jack.

Note

- While the unit is attached to a camera, adjustment of the recording volume level on the camera does not work.

- 1 Set the **AUTO/MAN/(LINK)** switch for the audio input jack (**INPUT1/INPUT2/INPUT3**) to “**MAN.**”

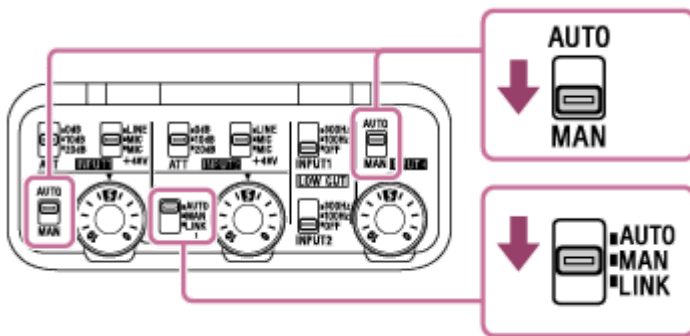

- 2 Rotate the **AUDIO LEVEL** dial to adjust the volume to the appropriate level.

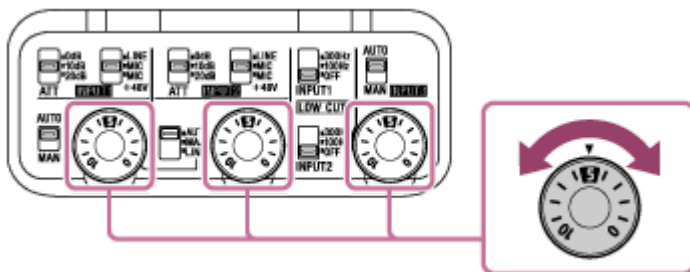

Make sure that the volume is at the appropriate level by monitoring the audio recording volume with the connected headphones or the volume level meter on the attached camera.

To automatically adjust the recording volume level

Set the **AUTO/MAN/(LINK)** switch to “**AUTO.**”

If the input audio is loud, the recording volume level will be lowered automatically to avoid audio distortion.

Hint

- To synchronize recording volume level adjustment of the input audio from the INPUT2 jack automatically to the INPUT1 jack, set the **AUTO/MAN/LINK** (INPUT2) switch to “**LINK.**” This synchronization comes in handy for receiving audio through the INPUT1 and INPUT2 jacks and recording the audio in stereo.
Setting the **AUTO/MAN** (INPUT1) switch to “**MAN**” and the **AUTO/MAN/LINK** (INPUT2) switch to “**LINK**” disables the **AUDIO LEVEL** dial for the INPUT2 jack. This allows you to adjust both of the recording volume levels of the input audio from the INPUT1 and INPUT2 jacks simultaneously with the **AUDIO LEVEL** dial for the INPUT1 jack.

- Using the supplied microphone
- Using a device, such as an external audio device

5-008-246-12(1) Copyright 2019 Sony Corporation

Selecting the audio input for recording audio to the channels on the camera

With the INPUT SELECT switch, select the audio input jack on the unit (INPUT1, INPUT2, or INPUT3) through which audio is recorded to the channels on the attached camera.

Note

- While the unit is attached to a camera, you cannot record the input audio from the built-in microphone or the microphone jack on the camera.

When only the INPUT1 jack has an external device connected:

Set the switch to "IN1." The input audio from the INPUT1 jack is recorded to both the CH1 and CH2 channels on the attached camera.

INPUT SELECT	Audio input jack	Channel to contain audio
IN1	INPUT1	CH1 and CH2

When both the INPUT1 and INPUT2 jacks have an external device connected:

Set the switch to "IN1·IN2." The input audio from the INPUT1 jack is recorded to the CH1 channel on the attached camera while the input audio from the INPUT2 jack is recorded to the CH2 channel.

INPUT SELECT	Audio input jack	Channel to contain audio
IN1·IN2	INPUT1	CH1
	INPUT2	CH2

Hint

- When using a stereo microphone with two XLR (3-pin, female type) plugs, connect the left-channel plug to the INPUT1 jack and the right-channel plug to the INPUT2 jack, and then set the INPUT SELECT switch to "IN1·IN2." In addition, by setting the AUTO/MAN/LINK (INPUT2) switch to "LINK" comes in handy for stereo recording as you can simultaneously adjust both the recording volume levels of the input audio from the INPUT1 and INPUT2 jacks.

When the INPUT3 jack has an external device connected:

Set the switch to "IN3." Stereo audio is received through the INPUT3 jack and its left-channel audio is recorded to the CH1 channel on the attached camera while the right-channel audio is recorded to the CH2 channel.

INPUT SELECT	Audio input jack	Channel to contain audio
IN3	INPUT3 (L)	CH1
	INPUT3 (R)	CH2

When the INPUT1, INPUT2, and INPUT3 jacks have an external device connected for simultaneous recording to 4 channels (provided that your camera supports 4-channel audio)

recording):

To record the input audio from the INPUT1 jack to the CH1 channel on the attached camera; the input audio from the INPUT2 jack to the CH2 channel; and the input audio from the INPUT3 jack to the CH3 and CH4 channels, set the switch to "IN1·IN2."

INPUT SELECT	Audio input jack	Channel to contain audio
IN1·IN2	INPUT1	CH1
	INPUT2	CH2
	INPUT3 (L)	CH3
	INPUT3 (R)	CH4

To record the input audio from the INPUT3 jack to the CH1 and CH2 channels on the attached camera; the input audio from the INPUT1 jack to the CH3 channel; and the input audio from the INPUT2 jack to the CH4 channel, set the switch to "IN3."

INPUT SELECT	Audio input jack	Channel to contain audio
IN3	INPUT1	CH3
	INPUT2	CH4
	INPUT3 (L)	CH1
	INPUT3 (R)	CH2

Related Topic

- [Using the supplied microphone](#)
- [Using a device, such as an external audio device](#)

Notes on use

- Before connecting/disconnecting an external microphone or device to/from the INPUT1 or INPUT2 jack, be sure to set the INPUT1 (LINE/MIC/MIC+48V) or INPUT2 (LINE/MIC/MIC+48V) switch to the position other than "MIC+48V." While the switch is set to "MIC+48V," plugging/unplugging the cable from the external microphone or device may cause a loud noise or a malfunction of the device.
- To protect the connector of the Multi Interface foot from damage while carrying around this unit, remove the unit from the camera, attach the connector protect cap to the foot and put the unit in the supplied case.
- While this unit is attached to a camera along with other accessories via a mounting bracket (not supplied), such as Sony VCT-55LH, do not hold the camera with hands for camera shooting. To avoid the risk of an incident caused by dropping, attach the camera to a tripod.
- While recording is in progress, operation and handling noises of a camera or a lens may be recorded. Touching this unit while recording is in progress causes a noise to be including in the recording.
- While recording is in progress, do not change the INPUT1, INPUT2, and DIGITAL/ANALOG switch settings.
- If the microphone of this unit is in proximity to a speaker, a howling effect (acoustic feedback) may occur. In such a case, move the unit away from the speaker to allow the maximum distance between the microphone and the speakers; or lower the speaker volume.
- Use of this unit in the vicinity of a radio tower may cause static noise in recordings. Before camera shooting, make sure that there is no radio tower nearby.
- Before changing the lens, be sure to remove this unit from the camera.
- Before changing the lens, make sure that no wind screen fibers are present on the surface of the lens and the camera body. If present, clean them off with a blower etc. and then change the lens.
- If dust or water droplets are present on the surface of the microphone, a successful recording may not be possible. Be sure to clean the microphone surface before using this unit.
- When you are finished with using this unit, lens cleaning is recommended.
- While a micro USB cable connected to XLR-K3M, using XLR-K3M may affect its performance.
- Using the supplied Extension Cable for Audio with products other than XLR-K3M may affect its performance, leading to accidents or malfunction.

Specifications

XLR Adaptor (XLR-A3M) unit

Audio input jacks	<p>INPUT1/INPUT2 jack (3-pin XLR/TRS, female type, phantom-power compatible)</p> <ul style="list-style-type: none"> ● MIC <ul style="list-style-type: none"> – Standard input level: -50 dBu (ATT = 10) – Standard recording volume level: -20 dBFS ● LINE <ul style="list-style-type: none"> – Standard input level: +4 dBu – Standard recording volume level: -20 dBFS <p>INPUT3 jack (stereo mini-jack, plug-in-power compatible)</p> <ul style="list-style-type: none"> ● Standard input level: -66 dBu ● Standard recording volume level: -20 dBFS <p>(0 dBu = 0.775 Vrms)</p>
Sampling frequency/the number of quantization bits	<p>48 kHz/16 bit, 48 kHz/24 bit*</p> <p>* Provided that your camera supports 24-bit audio recording.</p>
Frequency response	<p>20 Hz to 22,000 Hz +0 dB to -1 dB (XLR LINE, digital input)</p>
Dimensions (Approx.)	<p>113.2 mm × 106.1 mm × 79 mm (4 1/2 in. × 4 1/4 in. × 3 1/8 in.) (Width/Height/Depth) (excluding the cord and projecting parts)</p>
Mass (Approx.)	<p>187 g (6.6 oz)</p>
Operation temperatures	<p>0 °C to 40 °C (32 °F to 104 °F)</p>
Storage temperatures	<p>-20 °C to +55 °C (-4 °F to +131 °F)</p>

Microphone (ECM-XM1)

Type	Back electret condenser type
Pickup pattern	Super-directional
Front sensitivity	-30 dB (0 dB = 1 V/Pa, 1 kHz)

Dimensions (Approx.)	21 mm × 162 mm (27/32 in. × 6 1/2 in.) (Diameter/Length) (excluding the wind screen and cord)
Mass (Approx.)	121.5 g (4 oz)
Operation temperatures	0 °C to 40 °C (32 °F to 104 °F)
Storage temperatures	-20 °C to +55 °C (-4 °F to +131 °F)

Design and specifications are subject to change without notice.

5-008-246-12(1) Copyright 2019 Sony Corporation

XLR Adaptor Kit
XLR-K3M

Trademarks

- Multi Interface Shoe is a trademark of Sony Corporation.

5-008-246-12(1) Copyright 2019 Sony Corporation