

XLR Adaptor
XLR-A4

Use this Help Guide when you have issues or questions on how to use your XLR Adaptor.

Note

- When playing back video files recorded at 96 kHz or in 32bit float using this unit, use the camera that supports 96 kHz or 32bit float recording. If the video is played back on the camera that does not support these formats, it may not play back correctly.

**Supported camera models**

This unit is an XLR Adaptor for cameras with the Multi Interface Shoe.
For camera models compatible with this unit, view [here](#). (Another window will open.)

[About input and channel settings](#)

Specify the jacks for connecting microphones (not supplied) and the audio output channels based on the type and number of microphones you are using.

When the message “This accessory is not supported by the device and cannot be used.” is displayed on the camera:

View [here](#).

[Identifying the parts](#)**Preparations****[Unpacking](#)****[Attaching this unit directly to the camera/removing it](#)****[Attaching this unit to the camera using the supplied Shoe Audio Extension Cable](#)****[Attaching/removing a microphone \(not supplied\)](#)****[Using this unit as a computer audio interface](#)****[Using the supplied mini-stand](#)****Settings****[Selecting the digital or analog output type](#)****[Using a microphone \(not supplied\) or an external audio device](#)**

[Minimizing noise with the LOW CUT function](#)

[Adjusting the recording volume level](#)

[Selecting the input audio for output to each channel on the camera or computer](#)

[About input and channel settings](#)

About this unit

[Notes on use](#)

[Specifications](#)

[Trademarks](#)

Troubleshooting

[When the message “This accessory is not supported by the device and cannot be used.” is displayed on the camera:](#)

Identifying the parts

Body parts

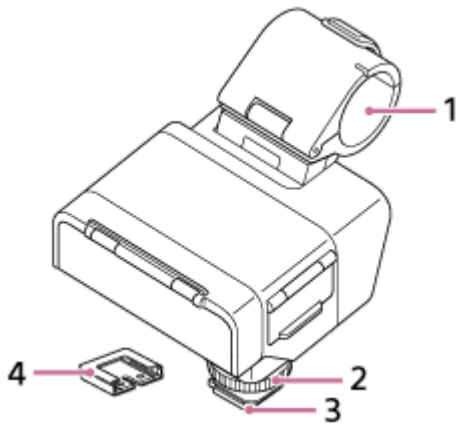

1. Microphone holder
2. Lock dial
3. Multi Interface foot

Note

- Do not touch the connector of the Multi Interface foot with bare hands.

4. Connector protect cap

Switches/dials/jacks

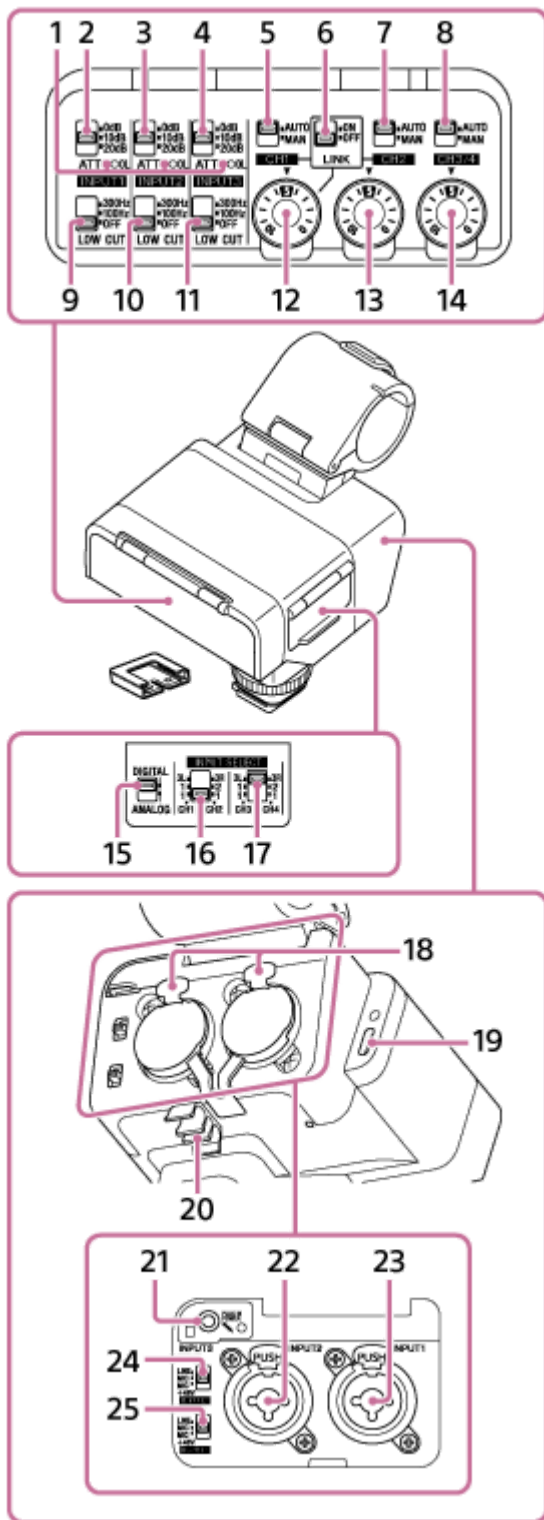

1. OL (overload) lamps

Light up when the input audio signal is large enough to cause analog clipping. In such cases, adjust the input level using the connected device or the ATT switch on this unit so that the lamp does not light up during operation.

2. ATT (INPUT1) switch

Select the standard input level of the INPUT1 jack. This switch setting is active when the INPUT1 (LINE/MIC/MIC+48V) switch is set to "MIC" or "MIC+48V."

3. ATT (INPUT2) switch

Select the standard input level of the INPUT2 jack. This switch setting is active when the INPUT2 (LINE/MIC/MIC+48V) switch is set to "MIC" or "MIC+48V."

4. ATT (INPUT3) switch

Select the standard input level of the INPUT3 jack.

5. **AUTO/MAN (CH1) switch**
Select the method (Auto/Manual) to adjust the volume level of the output audio to the CH1 on the camera or computer.
6. **LINK switch**
Setting the switch to "ON" allows the recording volume level of the audio output to CH2 on the camera or computer to automatically follow that of CH1. This is useful when recording in stereo to CH1 and CH2.
7. **AUTO/MAN (CH2) switch**
Select the method (Auto/Manual) to adjust the volume level of the output audio to the CH2 on the camera or computer.
8. **AUTO/MAN (CH3/4) switch**
Select the method (Auto/Manual) to adjust the volume level of the output audio to the CH3 and CH4 on the camera.
9. **LOW CUT (INPUT1) switch**
Use this switch to minimize unwanted noises by attenuating low-frequency components of the input audio from the INPUT1 jack. This switch setting is active when the INPUT1 (LINE/MIC/MIC+48V) switch is set to "MIC" or "MIC+48V."
10. **LOW CUT (INPUT2) switch**
Use this switch to minimize unwanted noises by attenuating low-frequency components of the input audio from the INPUT2 jack. This switch setting is active when the INPUT2 (LINE/MIC/MIC+48V) switch is set to "MIC" or "MIC+48V."
11. **LOW CUT (INPUT3) switch**
Use this switch to minimize unwanted noises by attenuating low-frequency components of the input audio from the INPUT3 jack.
12. **AUDIO LEVEL (CH1) dial**
Adjust the recording volume level of the output audio to the CH1 on the camera or computer.
13. **AUDIO LEVEL (CH2) dial**
Adjust the recording volume level of the output audio to the CH2 on the camera or computer.
14. **AUDIO LEVEL (CH3/4) dial**
Adjust the recording volume level of the output audio to the CH3 and CH4 on the camera.
15. **DIGITAL/ANALOG switch**
Select the output type, digital or analog.
If the Multi Interface Shoe on your camera is not compatible with the digital audio interface, set the switch to "ANALOG."
16. **INPUT SELECT (CH1/CH2) switch**
Select the input audio to output to the CH1 and CH2 on the camera or computer.
17. **INPUT SELECT (CH3/CH4) switch**
Select the input audio to output to the CH3 and CH4 on the camera.
18. **Release lever**
19. **USB Type-C® port**

Note

- The USB Type-C port on this unit is for connecting to a computer that supports USB audio input. As this port does not support power input from USB power supplies (including USB PD), the unit will not be powered even if connected to them.

20. **Cable holder**

21. INPUT3 jack (Stereo mini-jack, plug-in-power compatible)
 22. INPUT2 jack (3-pin XLR/TRS^{*}, female type, +48 V phantom-power compatible)
^{*} 3-pole jack (TIP: HOT, RING: COLD, SLEEVE: GND)
 23. INPUT1 jack (3-pin XLR/TRS^{*}, female type, +48 V phantom-power compatible)
^{*} 3-pole jack (TIP: HOT, RING: COLD, SLEEVE: GND)
 24. INPUT2 (LINE/MIC/MIC+48V) switch
Select the option suitable for the device connected to the INPUT2 jack.
 25. INPUT1 (LINE/MIC/MIC+48V) switch
Select the option suitable for the device connected to the INPUT1 jack.
-
-

Related Topic

- [Attaching this unit directly to the camera/removing it](#)
- [Attaching this unit to the camera using the supplied Shoe Audio Extension Cable](#)
- [Attaching/removing a microphone \(not supplied\)](#)
- [Using this unit as a computer audio interface](#)
- [Using the supplied mini-stand](#)
- [Selecting the digital or analog output type](#)
- [Using a microphone \(not supplied\) or an external audio device](#)
- [Minimizing noise with the LOW CUT function](#)
- [Adjusting the recording volume level](#)
- [Selecting the input audio for output to each channel on the camera or computer](#)
- [About input and channel settings](#)

XLR Adaptor
XLR-A4

Unpacking

If you find anything missing, please contact your dealer.
The number in the parentheses indicates the quantity.

- XLR Adaptor (XLR-A4) (1)
- Connector protect cap (attached) (2)
- Shoe Audio Extension Cable (1)
- Shoe Audio Extension Cable Reinforcement Attachment (1)
- Mini-stand (1)
- Case (1)
- Set of printed documentation

Attaching this unit directly to the camera/removing it

Attach this unit directly to the camera.

Note

- Before attaching/removing this unit to/from the camera, turn off the power to the camera.
- The microphone shown in the illustration is not supplied.

1 Remove the connector protect cap from this unit.

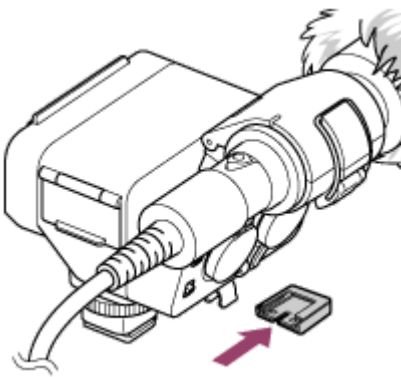

2 Slide the Multi Interface foot of this unit into the shoe on the camera (①), and then rotate the lock dial in the "LOCK" direction to firmly secure the unit (②).

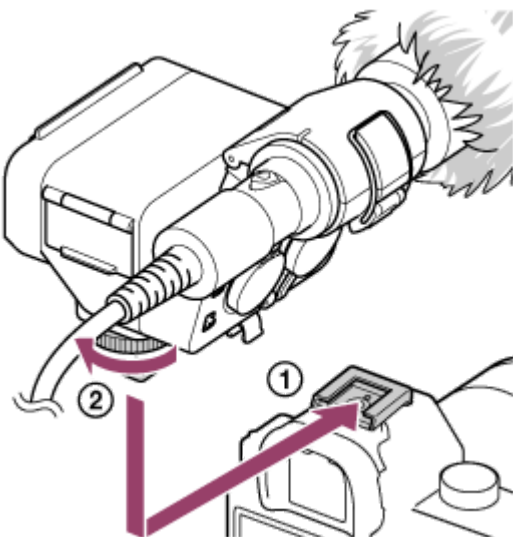

When it is difficult to insert the Multi Interface foot into the shoe, rotate the lock dial counterclockwise until it stops, and then try again.

To remove this unit

Turn off the power to the camera, rotate the lock dial counterclockwise until it stops, and then slide out the Multi Interface foot from the shoe.

Note

- When using the built-in flash of the camera, remove this unit from the camera.
- When you do not intend to use this unit, be sure to attach the connector protect cap back to the Multi Interface foot.

5-074-393-11(1) Copyright 2026 Sony Corporation

XLR Adaptor
XLR-A4

Attaching this unit to the camera using the supplied Shoe Audio Extension Cable

Attach this unit to the camera using the supplied Shoe Audio Extension Cable.

It is convenient, for example, when recording with a microphone (not supplied) attached to the unit from a distance.

Note

- Before attaching/removing the Shoe Audio Extension Cable to/from the camera, turn off the power to the camera.
- The Shoe Audio Extension Cable can be used with audio accessories for devices equipped with the Multi Interface Shoe. It is not compatible with external flashes.
For camera models compatible with the Shoe Audio Extension Cable, visit the website at:
<https://www.sony.net/dics/vmcsa1/>
- The microphone shown in the illustration is not supplied.

1 Remove the connector protect caps from this unit and the Shoe Audio Extension Cable.

2 Slide the Multi Interface foot of this unit into the shoe of the Shoe Audio Extension Cable (①), and then rotate the lock dial in the "LOCK" direction to firmly secure the unit (②).

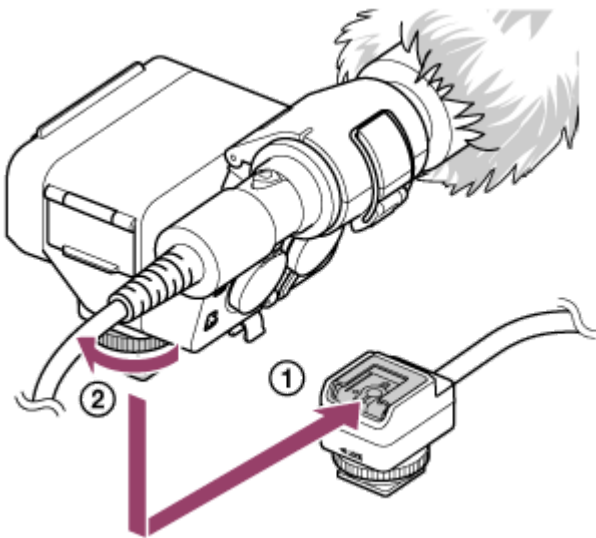

When it is difficult to insert the Multi Interface foot into the shoe, rotate the lock dial counterclockwise until it stops, and then try again.

3 Slide the Multi Interface foot of the Shoe Audio Extension Cable into the shoe on the camera (③), and then rotate the lock dial in the "LOCK" direction to firmly secure the Shoe Audio Extension Cable (④).

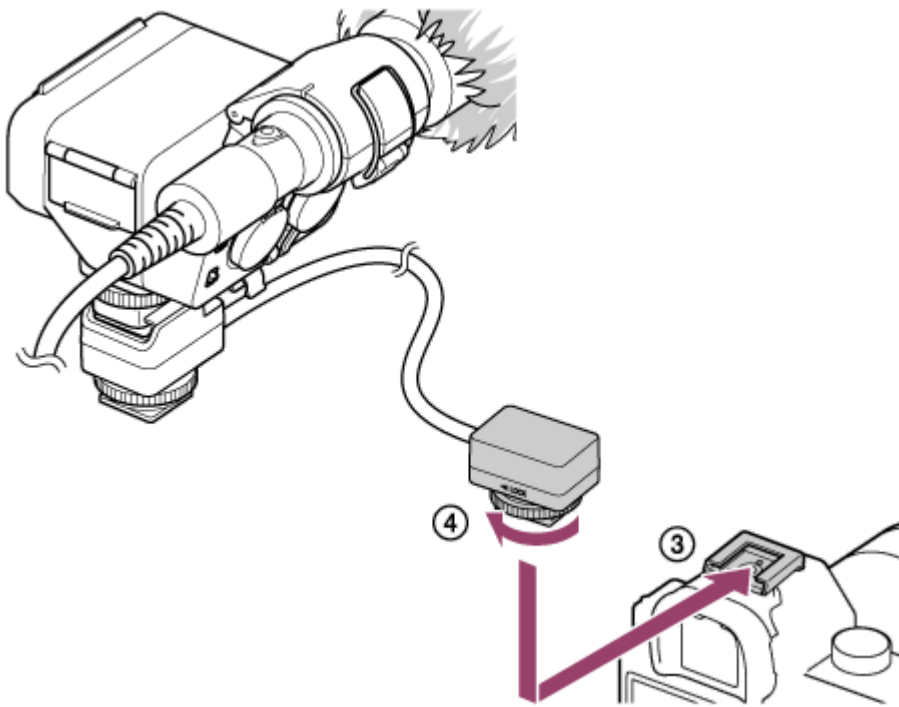

When it is difficult to insert the Multi Interface foot into the shoe, rotate the lock dial counterclockwise until it stops, and then try again.

To use the supplied shoe audio extension cable reinforcement attachment

When attaching this unit to a camera rig or similar equipment, use the shoe audio extension cable reinforcement attachment.

1. Attach the Shoe Audio Extension Cable to a camera rig or similar equipment, and then rotate the lock dial in the "LOCK" direction to firmly secure the Shoe Audio Extension Cable.

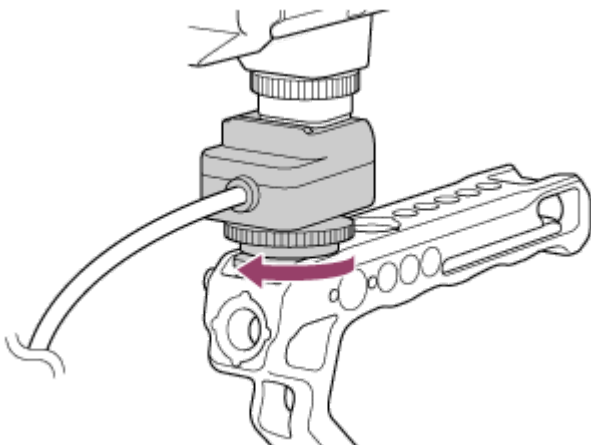

2. Attach the shoe audio extension cable reinforcement attachment so that it matches the shape of this unit and the Shoe Audio Extension Cable.

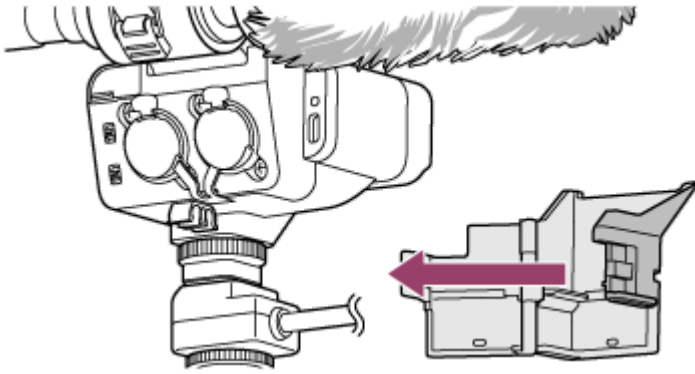

3. Align the hole (①) on the shoe audio extension cable reinforcement attachment with the protrusion (②), and push it in until it clicks into place to secure it.

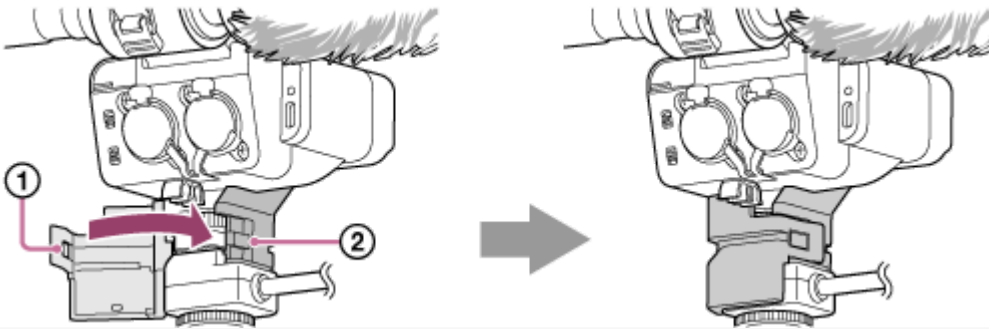

Note

- When using the built-in flash of the camera, remove this unit from the camera.
- When you do not intend to use this unit or the Shoe Audio Extension Cable, be sure to attach the connector protect cap back to the Multi Interface foot.
- When attaching the shoe audio extension cable reinforcement attachment, be careful not to pinch your fingers.
- When attaching the Shoe Audio Extension Cable to a camera rig, if the cable is longer than needed, secure the excess, for example, by wrapping it around the camera rig, so that it does not appear in the lens.

XLR Adaptor
XLR-A4

Attaching/removing a microphone (not supplied)

This topic explains an example of attaching a typical condenser microphone (monaural) to the INPUT1 jack on this unit.

Note

- Before attaching/removing the microphone to this unit, be sure to set the INPUT1 (LINE/MIC/MIC+48V) switch to the position other than "MIC+48V." While the switch is set to "MIC+48V," plugging/unplugging the microphone may cause a loud noise or a malfunction of the microphone.
- The microphone shown in the illustration is not supplied.

Hint

- It is recommended to attach a windscreen to the microphone. If necessary, use a microphone spacer as well.

1 Unlock the microphone holder and open the lid of the holder.

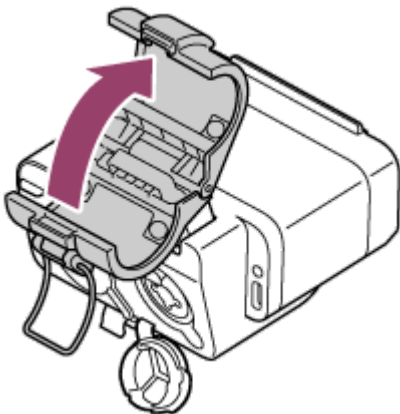

2 Place the microphone on the microphone holder, close the lid to lock the holder.



Note

- When closing and locking the lid, be careful not to pinch your fingers.

- 3 Connect the cable from the microphone to the INPUT1 jack on this unit.

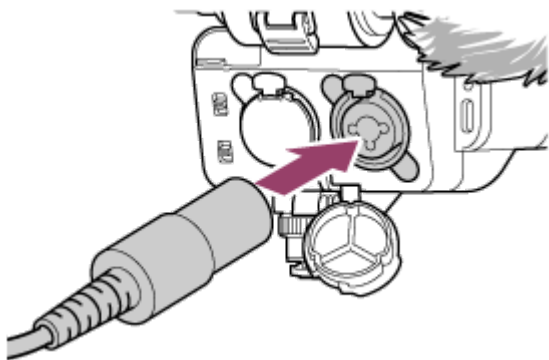

- 4 Tuck the cable from the microphone into the cable holder on this unit.

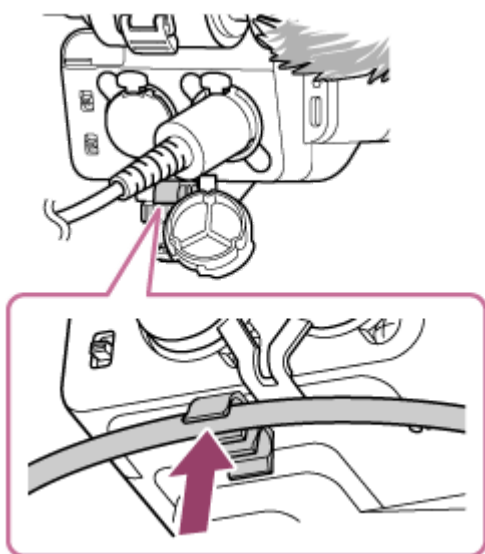

Do not pull the cable with excessive force or attach it to the cable holder while it is slack, as this may cause the microphone mounted on the microphone holder to tilt significantly.

To achieve sufficient vibration isolation effect, be sure to avoid a significant tilt of the microphone.

- 5 Set the INPUT1 (LINE/MIC/MIC+48V) switch to "MIC+48V."

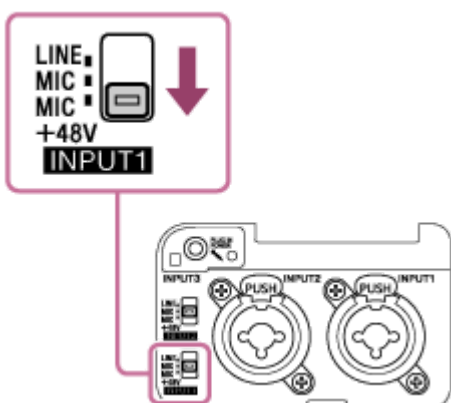

To remove the microphone

1. Set the INPUT1 (LINE/MIC/MIC+48V) switch to the position other than "MIC+48V."
2. Press and hold the release lever, grasp the plug of the cable from the microphone, and pull out the cable.
3. Remove the microphone from the microphone holder.

Related Topic

- [Using a microphone \(not supplied\) or an external audio device](#)

5-074-393-11(1) Copyright 2026 Sony Corporation

XLR Adaptor
XLR-A4

Using this unit as a computer audio interface

By connecting this unit to a computer that supports USB audio input, you can use the unit as a computer audio interface.

Note

- When connected to the computer, this unit operates using USB power supplied from the computer.
If the unit is attached to the camera, be sure to remove it from the camera before connecting it to the computer.
- For computer operations, refer to the operating instructions of the computer.
- For audio recording with this unit and the connected computer, your computer must be compatible with USB Audio Class 2.0.
- When connecting this unit to the computer, be sure to check the port type on your computer and use a compatible cable.
For a USB Type-C cable, use one that supports data transfer.
- The microphone shown in the illustration is not supplied.

1 Attach this unit to the supplied mini-stand.

For details, see "[Using the supplied mini-stand.](#)"

2 Use a USB Type-C cable (commercially available) to connect the USB Type-C port on this unit to the USB port on the computer.

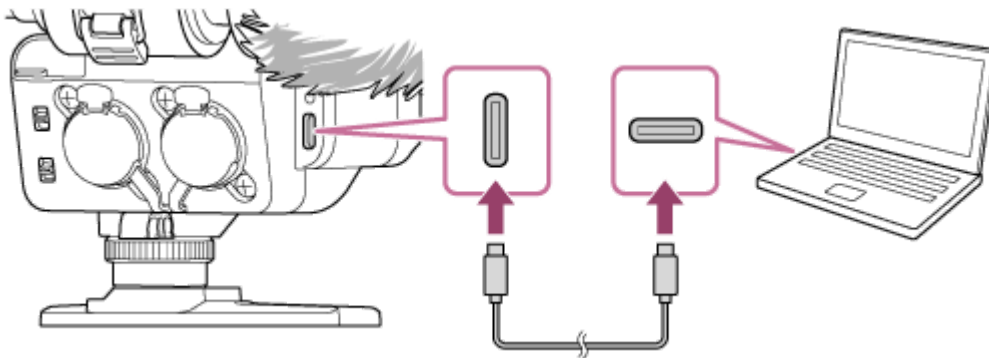

3 Make sure that this unit is recognized correctly and configure the audio settings on the computer.

- When connecting this unit to the computer, recording is limited to a maximum of 24 bit/96 kHz/2-channel.
- When connecting this unit to the computer, the following switch and dial settings are disabled.
 - DIGITAL/ANALOG switch
This unit outputs digital signals regardless of the switch selection: "DIGITAL" or "ANALOG."
 - INPUT SELECT (CH3/CH4) switch
 - AUTO/MAN (CH3/4) switch
 - AUDIO LEVEL (CH3/4) dial

Note

- Do not apply excessive force to this unit when you connect the unit to a computer. This may cause damage to the unit or the computer.
- Connecting this unit to a laptop computer that is not connected to an AC power source may deplete the battery power of the computer. Do not leave the unit connected to the computer for an extended period of time.
- Use of any customized or hand-built computer is not guaranteed. Depending on the USB devices used simultaneously, this unit may not operate correctly.
- Not all the computers are guaranteed for operation with this unit.
- When connecting this unit to a computer, be sure to use only the USB Type-C cable and connect them directly. The unit will fail to operate correctly when connected indirectly, for example, via a USB hub.
- While audio recording is in progress, operating the switches or dials on this unit may cause operation sounds to be included in the recording. Before changing the switch/dial settings, be sure to stop the recording.

5-074-393-11(1) Copyright 2026 Sony Corporation

Using the supplied mini-stand

Use the mini-stand when connecting this unit to a computer.

Note

- The microphone shown in the illustration is not supplied.

To attach the mini-stand

- 1 Remove the connector protect cap from this unit.

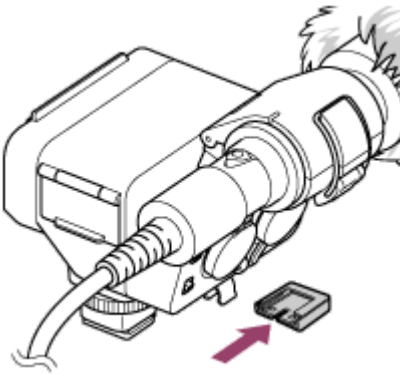

- 2 Slide the mini-stand into Multi Interface foot of this unit (①), and then rotate the lock dial in the “LOCK” direction to firmly secure the unit (②).

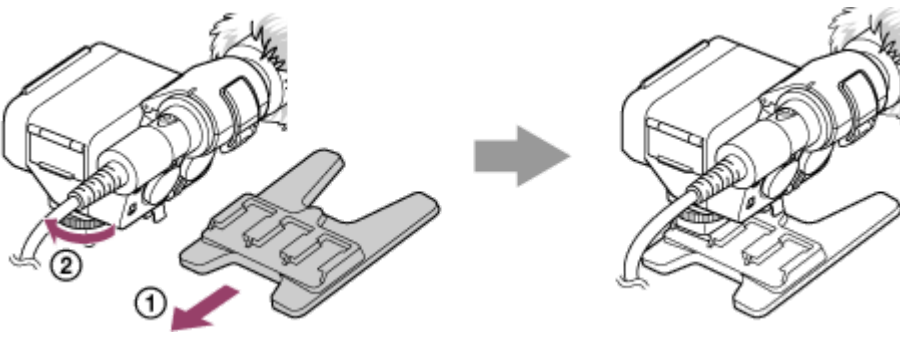

To remove the mini-stand

Rotate the lock dial counterclockwise until it stops, and then slide the mini-stand in the opposite direction from attachment.

Hint

- The mini-stand has 3 mounting positions. Attach this unit to the position that allows for balanced mounting according to your microphone (not supplied).
- Depending on the combination of your microphone and this unit, the mini-stand may not be able to support them. In such a case, secure the microphone separately.

Note

- When you do not intend to use this unit, be sure to attach the connector protect cap back to the Multi Interface foot.

Related Topic

- [Using this unit as a computer audio interface](#)

5-074-393-11(1) Copyright 2026 Sony Corporation

Selecting the digital or analog output type

Set the audio output type.

Note

- The microphone shown in the illustration is not supplied.

1 Change the DIGITAL/ANALOG switch setting to suit your camera.

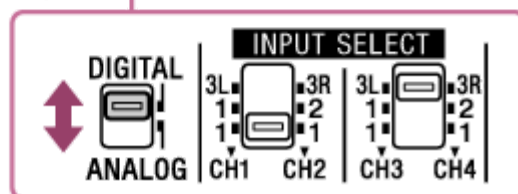
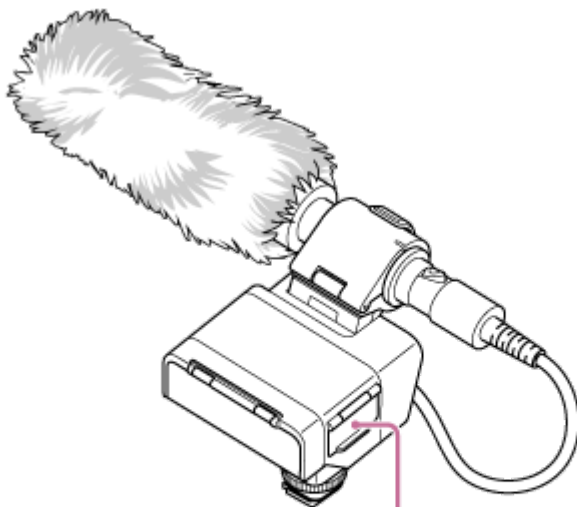

Note

- If the Multi Interface Shoe on your camera is not compatible with the digital audio interface, set the switch to “ANALOG.”
- When connecting this unit to the computer, the unit outputs digital signals regardless of the switch selection: “DIGITAL” or “ANALOG.”

Using a microphone (not supplied) or an external audio device

Use a microphone or an external audio device, such as an audio mixer, for recording.

Note

- Before connecting/disconnecting a device to/from the INPUT1 or INPUT2 jack, be sure to set the INPUT1 (LINE/MIC/MIC+48V) or INPUT2 (LINE/MIC/MIC+48V) switch to the position other than “MIC+48V.” While the switch is set to “MIC+48V,” plugging/unplugging the device may cause a loud noise or a malfunction of the device.
- When connecting this unit to the computer, recording is limited to a maximum of 2-channel.
- The microphone shown in the illustration is not supplied.

1 Connect your desired device to the INPUT1, INPUT2, or INPUT3 jack on this unit.



When using either the INPUT1 or INPUT2 jack, connect the device to the INPUT1 jack.
When connecting the device to the INPUT3 jack, proceed to step 3.

2 Select an input audio source.

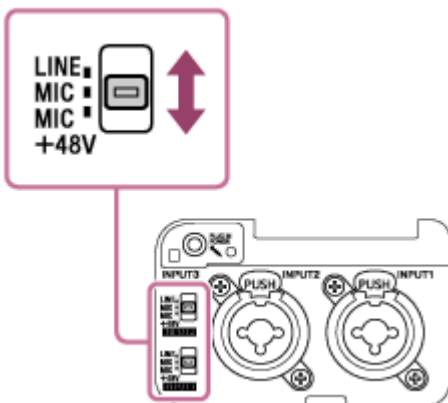

Depending on the device connected to the INPUT1 or INPUT2 jack, set the INPUT1 (LINE/MIC/MIC+48V) or INPUT2 (LINE/MIC/MIC+48V) switch as follows:

- LINE (Standard input level at +4 dBu (0 dBu = 0.775 Vrms)): An external audio device (e.g., an audio mixer)
- MIC: A dynamic microphone or a microphone with the built-in battery
- MIC+48V: A microphone compatible with +48V power (phantom power)

3 Use the INPUT SELECT switch to select the input audio to be output to each channel on the camera or computer.

You can select the input audio to be output to each channel on the camera or computer from INPUT1, INPUT2, or INPUT3 on this unit.

For details, see “[Selecting the input audio for output to each channel on the camera or computer.](#)”

4 Use the ATT (INPUT1/INPUT2/INPUT3) switch of the jack to which the device is connected to set the standard input level of the microphone.

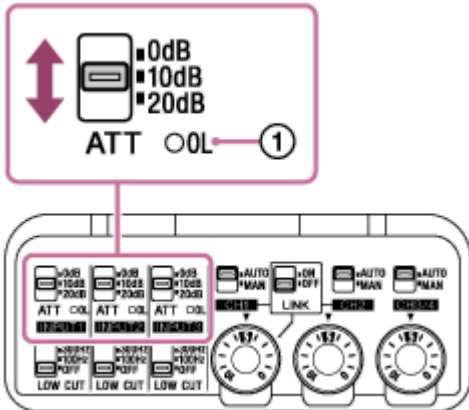

Select the level suitable for the sensitivity of the connected microphone or for the volume level of the input audio.

- 0dB: Suitable for recording with a low-sensitivity microphone while amplifying sounds.
 - INPUT1/INPUT2: Standard input level at –60 dBu
 - INPUT3: Standard input level at –76 dBu
- 10dB: Recommended input level for recording human voices.
 - INPUT1/INPUT2: Standard input level at –50 dBu
 - INPUT3: Standard input level at –66 dBu
- 20dB: Suitable for recording with a high-sensitivity microphone while keeping the sound volume low.
 - INPUT1/INPUT2: Standard input level at –40 dBu
 - INPUT3: Standard input level at –56 dBu

Note

- Each ATT switch (for INPUT1 and INPUT2) is enabled only when its respective INPUT switch, INPUT1 (LINE/MIC/MIC+48V) or INPUT2 (LINE/MIC/MIC+48V), is set to “MIC” or “MIC+48V.” When the switch is set to “LINE,” the standard input level is fixed at +4 dBu, so it does not change even if the ATT switch is used.

Hint

- When the input audio signal is large enough to cause analog clipping, the OL (overload) lamp (①) on this unit will light up. In such cases, adjust the input level using the connected device or the ATT switch on the unit so that the lamp does not light up during operation.

5 Adjust the recording volume level.

For detailed instructions on adjustment, see [“Adjusting the recording volume level.”](#)

Hint

- If the noise from the jacks with no device connected is disturbing, set the INPUT1 (LINE/MIC/MIC+48V) or INPUT2 (LINE/MIC/MIC+48V) switch to “LINE.”

Related Topic

- [Selecting the digital or analog output type](#)
- [Minimizing noise with the LOW CUT function](#)
- [About input and channel settings](#)

5-074-393-11(1) Copyright 2026 Sony Corporation

XLR Adaptor
XLR-A4

Minimizing noise with the LOW CUT function

Minimize unwanted noises, such as wind noise, air-conditioning noise, and vibration noise, by attenuating low-frequency components of the input audio from the INPUT1, INPUT2 or INPUT3 jack.

- 1 Change the LOW CUT (INPUT1/INPUT2/INPUT3) switch setting.

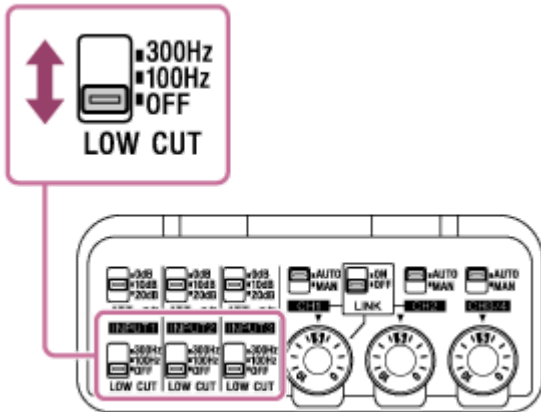

Select either “300Hz” or “100Hz” depending on the noise to minimize.

Note

- Each LOW CUT switch (for INPUT1 and INPUT2) is enabled only when its respective INPUT switch, INPUT1 (LINE/MIC/MIC+48V) or INPUT2 (LINE/MIC/MIC+48V), is set to “MIC” or “MIC+48V.”

Related Topic

- [Using a microphone \(not supplied\) or an external audio device](#)

Adjusting the recording volume level

Adjust the recording volume level of the input audio from the INPUT1, INPUT2, or INPUT3 jack.

Note

- While this unit is attached to the camera, adjustment of the recording volume level on the camera does not work.
- When connecting this unit to the computer, recording is limited to a maximum of 2-channel.

- 1 Set the AUTO/MAN switch of the channel (CH1/CH2/CH3/4) to which the audio signal is output to "MAN."

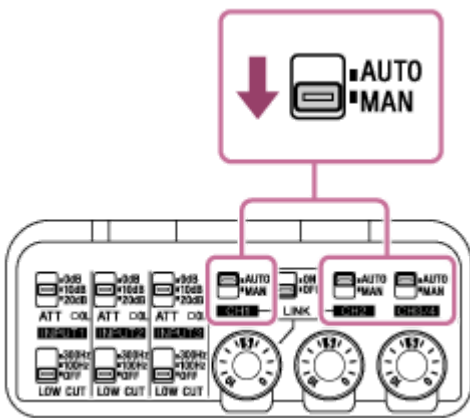

- 2 Rotate the AUDIO LEVEL dial to adjust the volume to the appropriate level.

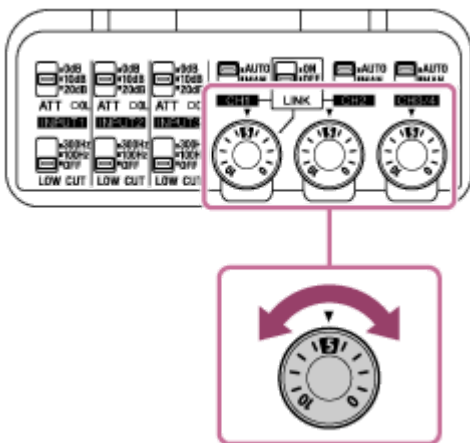

Check whether the level is appropriate. You can monitor it via the level meter on the camera or computer, or with headphones by connecting them to the camera or computer.

To automatically adjust the recording volume level

Set the AUTO/MAN switch to "AUTO."

This setting prevents distortion by automatically lowering the recording volume level when the input audio signal is too large.

Hint

- To automatically make the recording volume level adjustment for audio output to CH2 follow that of CH1, set the LINK switch to “ON.” This is useful when recording in stereo to CH1 and CH2.
If the AUTO/MAN switch for CH1 is set to “MAN” and the LINK switch is set to “ON,” the AUDIO LEVEL dial for CH2 is disabled. In this case, use the AUDIO LEVEL dial for CH1 instead to simultaneously adjust the recording volume level of the audio output to both CH1 and CH2.
- For 32bit float recording, the automatic level adjustment of the recording volume level is disabled. The recording volume level is fixed at the level determined by setting the AUTO/MAN switch to “MAN” and the AUDIO LEVEL dial to “5.” As long as no analog clipping occurs, you can record sounds ranging from quiet to loud without distortion.
You can adjust the gain of the recorded file to restore the audio to an optimal, distortion-free level for editing.

Related Topic

- [Using a microphone \(not supplied\) or an external audio device](#)
- [About input and channel settings](#)

5-074-393-11(1) Copyright 2026 Sony Corporation

Selecting the input audio for output to each channel on the camera or computer

You can select the input audio to be output to each channel on the camera or computer from INPUT1, INPUT2, or INPUT3 by setting the INPUT SELECT switch on this unit.

Note

- Set the number of channels to use in the camera or computer menu.
- When connecting this unit to the computer, recording is limited to a maximum of 2-channel.
- The microphone shown in the illustration is not supplied.

1 Change the INPUT SELECT switch setting.

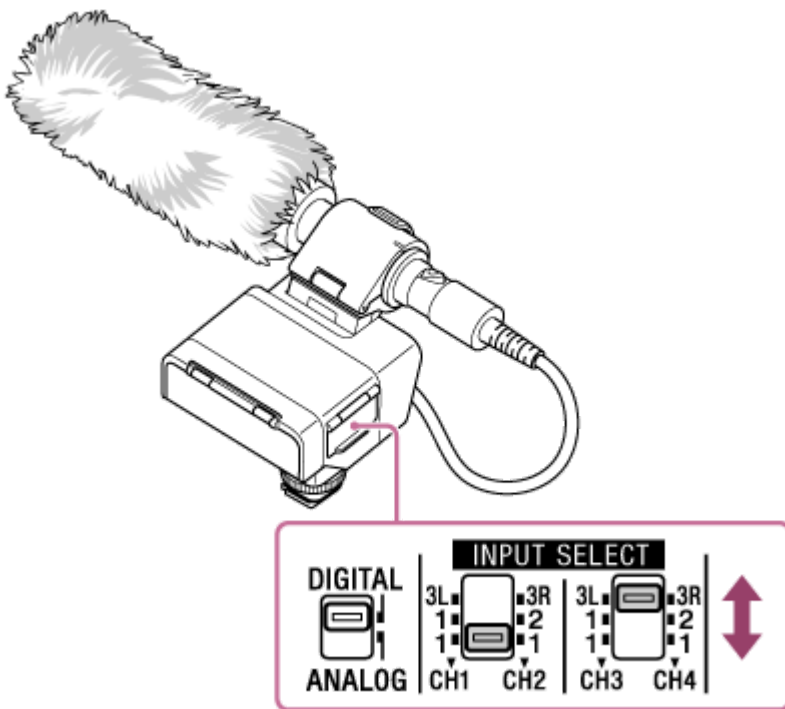

● **When outputting to CH1 and CH2**

Set the INPUT SELECT (CH1/CH2) switch accordingly.

Audio input jack	INPUT SELECT (CH1/CH2) switch settings	Audio output channel
INPUT1 only	1/1	CH1: INPUT1 CH2: INPUT1
INPUT1 and INPUT2	1/2	CH1: INPUT1 CH2: INPUT2
INPUT3	3L/3R	CH1: INPUT3L CH2: INPUT3R

● **When outputting to CH3 and CH4**

Set the INPUT SELECT (CH3/CH4) switch accordingly.

Audio input jack	INPUT SELECT (CH3/CH4) switch settings	Audio output channel
INPUT1 only	1/1	CH3: INPUT1 CH4: INPUT1
INPUT1 and INPUT2	1/2	CH3: INPUT1 CH4: INPUT2
INPUT3	3L/3R	CH3: INPUT3L CH4: INPUT3R

For detailed examples of specific connections and settings, see “[About input and channel settings.](#)”

Related Topic

- [Using a microphone \(not supplied\) or an external audio device](#)

XLR Adaptor
XLR-A4

About input and channel settings

Select the input jacks and audio output channels according to the type and number of microphones (not supplied) you are using.

Using a single microphone

- When using a monaural microphone with an XLR plug**
 Connect the microphone to the INPUT1 jack and set the INPUT SELECT (CH1/CH2) switch to “1/1.”
 This enables dual-mono recording to CH1 and CH2, which is suitable for documentary recording.



You can also set the INPUT SELECT (CH3/CH4) switch to “1/1” to record audio on CH3 and CH4 at a different recording volume level from CH1 and CH2 as a backup.

To adjust the recording volume level, set the AUTO/MAN (CH3/4) switch to “MAN” and use the AUDIO LEVEL (CH3/4) dial.



- When using a stereo microphone with two XLR plugs (L/R)**
 Connect the left-channel plug to the INPUT1 jack and the right-channel plug to the INPUT2 jack, and then set the INPUT SELECT (CH1/CH2) switch to “1/2.”
 This enables stereo recording to CH1 and CH2, which is suitable for live performances or field recording.

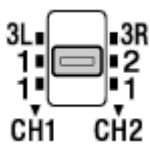

You can also set the INPUT SELECT (CH3/CH4) switch to “1/2” to record audio on CH3 and CH4 at a different recording volume level from CH1 and CH2 as a backup.

To adjust the recording volume level, set the AUTO/MAN (CH3/4) switch to “MAN” and use the AUDIO LEVEL (CH3/4) dial.

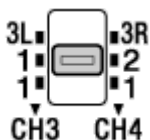

- When using a stereo microphone with a stereo mini plug**
 Connect the microphone to the INPUT3 jack and set the INPUT SELECT (CH1/CH2) switch to “3L/3R.”
 This enables stereo recording to CH1 and CH2, which is suitable for live performances or field recording.

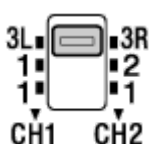

You can also set the INPUT SELECT (CH3/CH4) switch to “3L/3R” to record audio on CH3 and CH4 at a different recording volume level from CH1 and CH2 as a backup.

To adjust the recording volume level, set the AUTO/MAN (CH3/4) switch to “MAN” and use the AUDIO LEVEL (CH3/4) dial.

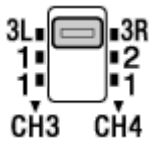

Hint

- When using a single microphone, it is not necessary to output audio to all channels (CH1 through CH4). Set the number of channels to use and the INPUT SELECT switch as needed.

Using multiple microphones

- **When using a monaural microphone with an XLR plug and a stereo microphone with a stereo mini plug**

Connect the monaural microphone to the INPUT1 jack and the stereo microphone to the INPUT3 jack.

This is suitable when recording from multiple microphones separately, such as during interviews.

To output the audio from the monaural microphone to CH1 and CH2, and the audio from the stereo microphone to CH3 and CH4, set the INPUT SELECT (CH1/CH2) switch to “1/1” and the INPUT SELECT (CH3/CH4) switch to “3L/3R.”

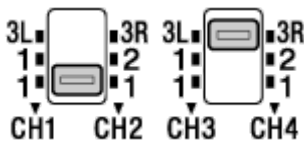

To output the audio from the monaural microphone to CH3 and CH4, and the audio from the stereo microphone to CH1 and CH2, set the INPUT SELECT (CH1/CH2) switch to “3L/3R” and the INPUT SELECT (CH3/CH4) switch to “1/1.”

- **When using two stereo microphones: one with XLR plugs (L/R) and one with a stereo mini plug**

Connect the left-channel plug to the INPUT1 jack, the right-channel plug to the INPUT2 jack, and the stereo mini plug to the INPUT3 jack.

This is suitable for recording the speaker's voice separately from ambient sound, such as during outdoor interviews.

To output the audio from the stereo microphone with XLR plugs to CH1 and CH2, and the audio from the stereo microphone with a stereo mini plug to CH3 and CH4, set the INPUT SELECT (CH1/CH2) switch to “1/2” and the INPUT SELECT (CH3/CH4) switch to “3L/3R.”

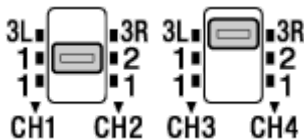

To output the audio from the stereo microphone with XLR plugs to CH3 and CH4, and the audio from the stereo microphone with a stereo mini plug to CH1 and CH2, set the INPUT SELECT (CH1/CH2) switch to “3L/3R” and the INPUT SELECT (CH3/CH4) switch to “1/2.”

Related Topic

- [Adjusting the recording volume level](#)
- [Selecting the input audio for output to each channel on the camera or computer](#)

XLR Adaptor

XLR-A4

Notes on use

- The supplied Shoe Audio Extension Cable can be used with audio accessories for devices equipped with the Multi Interface Shoe. It is not compatible with external flashes.
- This unit is not dust-proof, splash-proof, or waterproof.
- When using the built-in flash of the camera, remove this unit from the camera.
- To avoid the risk of a fire or an electric shock, observe the following:
 - Do not disassemble or alter this unit.
 - Do not use this unit with wet hands.
 - Do not allow ingress of water or foreign matters (metal, flammable substances, etc.) to this unit.
 - Do not use this unit in a place subject to water splashes, high humidity, dust, oil fumes, and steam.
- To avoid the risk of damage or a malfunction, observe the following:
 - This unit is precision equipment. Do not drop the unit, hit it, or subject it to a strong physical impact.
 - Do not touch the electrical contacts on this unit with bare hands.
 - Do not use or store this unit in a place subject to high temperatures and humidity.
 - When using this unit outdoors, keep the unit from exposure to rain or seawater.
- For interior inspection and repair of this unit, contact your Sony dealer or local authorized Sony service facility.
- Recording audio at 96 kHz or in 32bit float with this unit requires a compatible camera.
- When recording audio at 96 kHz or in 32bit float with this unit, a high-speed memory card may be required. For information on compatible memory cards, refer to the Help Guide for your camera.
- Before connecting/disconnecting a microphone (not supplied) or an external device to/from the INPUT1 or INPUT2 jack, be sure to set the INPUT1 (LINE/MIC/MIC+48V) or INPUT2 (LINE/MIC/MIC+48V) switch to the position other than "MIC+48V." While the switch is set to "MIC+48V," plugging/unplugging the microphone or external device may cause a loud noise or a malfunction of the device.
- To protect the connector of the Multi Interface foot from damage while carrying around this unit, remove the unit from the camera, attach the connector protect cap to the foot and put the unit in the supplied case.
- While this unit is attached to a camera along with other accessories via a mounting bracket, do not hold the camera with hands for camera shooting. To avoid the risk of an incident caused by dropping, attach the camera to a tripod.
- While recording is in progress, operation and handling noises of a camera or a lens may be recorded. Touching this unit while recording is in progress causes a noise to be included in the recording.
- While recording is in progress, do not change the INPUT1, INPUT2, and DIGITAL/ANALOG switch settings.

- If the microphone of this unit is in proximity to a speaker, a howling effect (acoustic feedback) may occur. In such a case, move the unit away from the speaker to allow the maximum distance between the microphone and the speakers; or lower the speaker volume.
- Before changing the lens, make sure that no wind screen (not supplied) fibers are present on the surface of the lens and the camera body. If present, clean them off with a blower etc. and then change the lens.
- If dust or water droplets are present on the surface of the microphone, a successful recording may not be possible. Be sure to clean the microphone surface before using this unit.
- Before changing the lens, be sure to remove this unit from the camera.
- When you are finished with using this unit, lens cleaning is recommended.
- Note that the performance cannot be guaranteed when using this unit attached to a camera while a USB cable is connected to the unit.
- Use of this unit in the vicinity of a radio tower may cause static noise in recordings. Before camera shooting, make sure that there is no radio tower nearby.

XLR Adaptor
XLR-A4

Specifications

<p>Audio input jacks</p>	<p>INPUT1/INPUT2 jack (3-pin XLR/TRS^{*1}, female type, +48 V phantom-power compatible)</p> <ul style="list-style-type: none"> ● MIC <ul style="list-style-type: none"> – Standard input level: –50 dBu (ATT = 10) – Standard recording volume level: –20 dBFS ● LINE <ul style="list-style-type: none"> – Standard input level: +4 dBu – Standard recording volume level: –20 dBFS <p>INPUT3 jack (stereo mini-jack, plug-in-power compatible)</p> <ul style="list-style-type: none"> ● Standard input level: –66 dBu (ATT = 10) ● Standard recording volume level: –20 dBFS <p>(0 dBu = 0.775 Vrms)</p>
<p>Sampling frequency/the number of quantization bits</p>	<p>48 kHz/16 bit, 48 kHz/24 bit^{*2}, 48 kHz/32bit float^{*2}, 96 kHz/24 bit^{*2}, 96 kHz/32bit float^{*2}</p>
<p>Frequency response</p>	<p>At a sampling frequency of 48 kHz: 20 Hz to 22 000 Hz ±1 dB (XLR LINE, digital input) At a sampling frequency of 96 kHz: 20 Hz to 40 000 Hz ±1 dB (XLR LINE, digital input)</p>
<p>Rated Voltage</p>	<p>7.82 V </p>
<p>Power consumption (Approx.)</p>	<p>1.8 W</p>
<p>Dimensions (Approx.)</p>	<p>113.2 mm × 99.8 mm × 80.0 mm (4 1/2 in. × 4 in. × 3 1/4 in.) (W/H/D) (excluding the projecting parts)</p>
<p>Mass (Approx.)</p>	<p>198 g (7.0 oz.)</p>
<p>Operating temperature</p>	<p>0 °C to 40 °C (32 °F to 104 °F)</p>
<p>Storage temperature</p>	<p>–20 °C to +55 °C (–4 °F to +131 °F)</p>

*1 3-pole jack (TIP: HOT, RING: COLD, SLEEVE: GND)

*2 Provided that your camera supports these formats.

Design and specifications are subject to change without notice.

XLR Adaptor
XLR-A4

Trademarks

- “Multi Interface Shoe” is a trademark of Sony Group Corporation.
- USB Type-C® and USB-C® are registered trademarks of USB Implementers Forum.

XLR Adaptor
XLR-A4

When the message “This accessory is not supported by the device and cannot be used.” is displayed on the camera:

Do the following in the listed order.

Note

- The microphone shown in the illustration is not supplied.

1 Make sure that your camera is compatible with this unit.

For camera models compatible with this unit, visit the website at:

<https://www.sony.net/dics/xlra4/>

Note

- In combination with any camera model that is not listed on the above website, the unit does not work.

2 To use the camera that is not compatible with the digital audio interface in combination with this unit, set the DIGITAL/ANALOG switch on the unit to “ANALOG.”

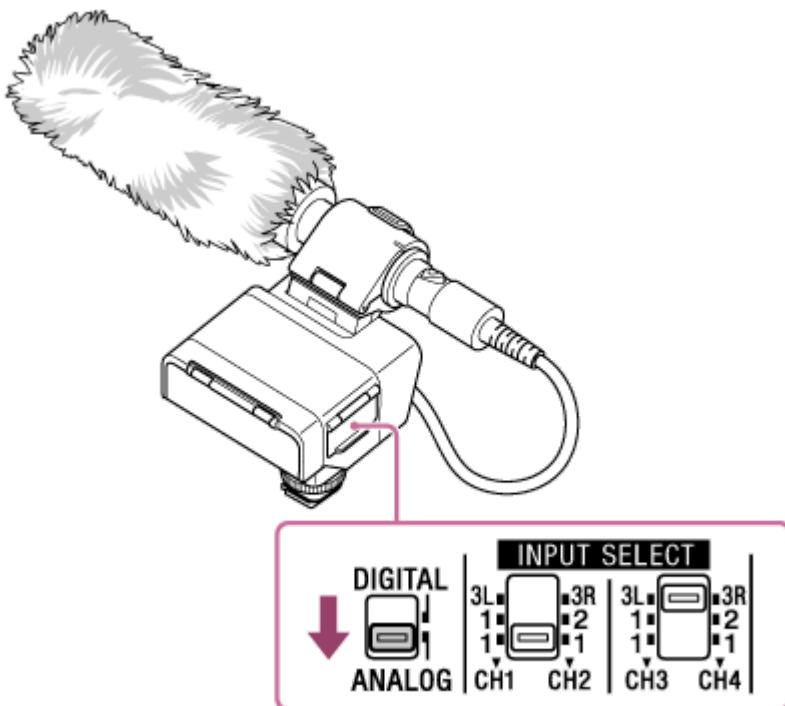

3 Clean the contacts on this unit and the camera. When either or both of the contacts are soiled with dust or the like, the camera may fail to detect that the unit is attached. To clean the contacts, use a cotton swab or a dry, soft cloth (e.g., a cleaning cloth). Do not use water or chemicals for cleaning.

Note

- Make sure that the DIGITAL/ANALOG switch is slid all the way to either “ANALOG” or “DIGITAL.” If the switch is located in between, this unit may not work properly.

5-074-393-11(1) Copyright 2026 Sony Corporation