

Wireless Microphone
UO-ULTMIC1



Model: YY7867E

Design and specifications are subject to change without notice.

Quick Start Guide

Let's start to use

1

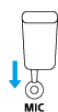

Connect the receiver to the speaker.

2

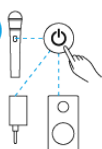

Turn on the power for the microphone, receiver, and speaker.

3

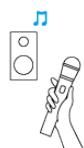

Sing or talk on the microphone.

Getting started

[Parts and controls](#)

Power source/charging

- [Charging the microphone and receiver](#)
- [Automatic Power Off \(power saving\) function](#)

Using the microphone

[Using the microphone with a speaker](#)

[About the Duet Assist function](#)

Information

[About the indicators](#)

Notes on use

- [Precautions](#)
- [To prevent burning or malfunction caused by exposure to water](#)
- [In case of water exposure](#)
- [Notes on charging](#)
- [How to care for the microphone and receiver](#)
- [Licenses](#)
- [Trademarks](#)

Troubleshooting

[Troubleshooting](#)

[Pair the microphone and receiver again](#)

[There is acoustic feedback](#)

[Restart the microphone or receiver](#)

Specifications

[Specifications](#)

Wireless Microphone
UO-ULTMIC1

Parts and controls

Microphone

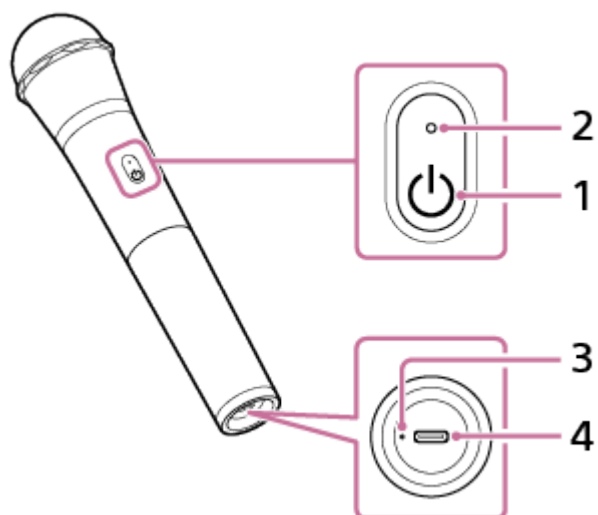

1. power button
2. Power indicator
3. Charge indicator
4. DC input port (USB Type-C®)

Receiver

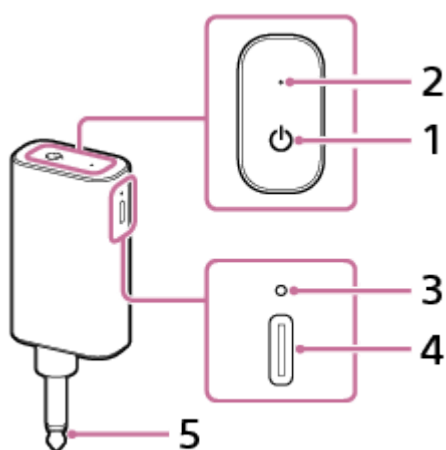

1. power button
2. Power indicator
3. Charge indicator
4. DC input port (USB Type-C)
5. Standard plug (Φ 6.3 mm)

Related Topic

- [About the indicators](#)

5-066-054-11(1) Copyright 2025 Sony Corporation

Wireless Microphone
UO-ULTMIC1

Charging the microphone and receiver

You can charge the microphone and receiver by connecting a commercially available USB AC adaptor and the supplied USB Type-C cable to a power outlet.

When using the microphone and receiver for the first time, charge them for at least 1 hour before turning on the power. After charging the microphone and receiver, you can use them with the built-in rechargeable batteries only.

Recommended USB AC adaptor

Use a commercially available USB AC adaptor with an output of 5 V 0.5 A (500 mA).

1 Connect the microphone or receiver to a power outlet for charging.

Use the supplied USB Type-C cable to connect the DC input port of the microphone or receiver to a USB AC adaptor. Then, connect the USB AC adaptor into a power outlet.

● Microphone

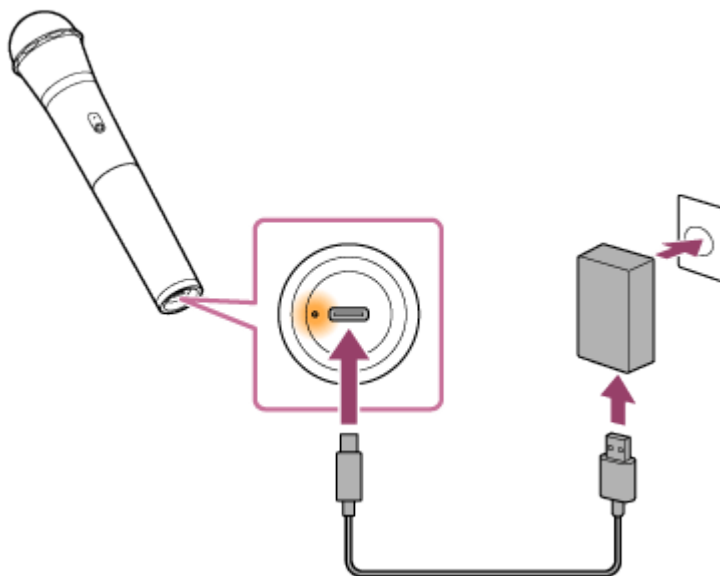

● Receiver

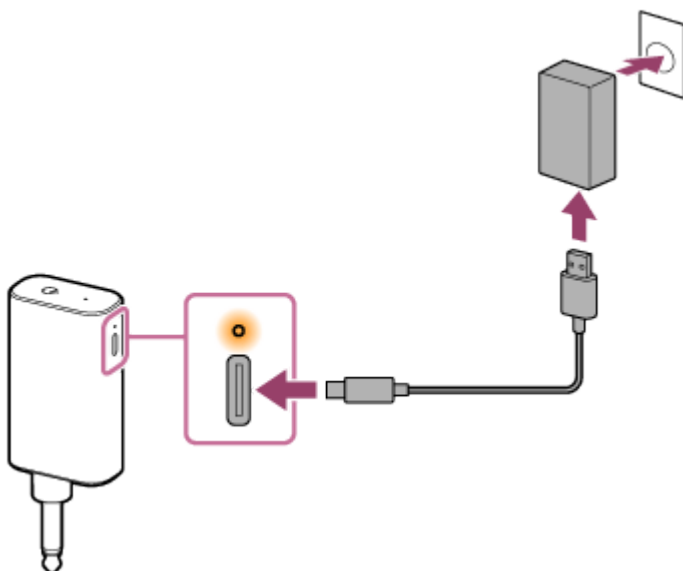

The charge indicators on the microphone and receiver light up in orange while charging is in progress. The indicators turn off when charging is complete.

It takes approximately 2.5 hours (*) to fully charge the built-in rechargeable battery from an empty state when the microphone or receiver is turned off.

(*) This is the estimated time when using a commercially available USB AC adaptor with an output of 5 V 0.5 A (500 mA).

How to check if the built-in rechargeable battery is fully charged

Connect the microphone or receiver to a power outlet using a commercially available USB AC adaptor. If the built-in rechargeable battery is fully charged, the charge indicator will light up in orange and turn off approximately 1 minute later.

Battery hours of the built-in rechargeable battery

- Microphone
Approximately 20 hours
- Receiver
Approximately 20 hours

Charging time for the built-in rechargeable battery

- Microphone
Approximately 2.5 hours (*)
A 10-minute charge provides approximately 120 minutes of use.
- Receiver
Approximately 2.5 hours (*)
A 10-minute charge provides approximately 120 minutes of use.

(*) This is the estimated time required to fully charge the built-in rechargeable battery from an empty state under the following conditions.
The microphone or receiver is turned off.
A commercially available USB AC adaptor with an output of 5 V 0.5 A (500 mA) is used.

Note

- The charging time depends on the output current of the commercially available USB AC adaptor. Additionally, the types or specifications of the USB AC adaptor and USB cable may result in a longer charging time than the one mentioned above. Charging time may also vary depending on the surrounding temperature and usage conditions.

The above times are measured using the company's specified audio source.

Charging and usage times may vary depending on the surrounding temperature and usage conditions.

Hint

- The microphone or receiver can be charged even if the power is on, as long as it is connected to a power outlet using a USB AC adaptor. However, depending on usage conditions, charging time may be longer. For optimal charging, it is recommended to turn off the microphone or receiver.
- The microphone or receiver can also be charged by connecting it to a speaker with a USB charging-compatible port. However, this does not guarantee compatibility with all speakers.

Note

- Depending on the types or specifications of the USB AC adaptor, the remaining power of the built-in rechargeable battery may decrease or the power may turn off even when the microphone or receiver is connected to a power outlet. This is not a malfunction. In such cases, turn off the power and fully charge the microphone or receiver before use.
- Charging will stop in environments with extremely high or low temperatures for safety reasons. Additionally, charging may stop if it continues for an extended period. To resume charging, disconnect and reconnect the USB cable within the usable temperature range of 5 °C to 35 °C (41 °F to 95 °F).

- If the built-in rechargeable battery experiences a high load during charging, charging will stop for safety reasons. In such cases, stop using the microphone or receiver.
- The microphone and receiver are not designed to be waterproof or dustproof. Depending on how they are used, water or dust may get inside, potentially causing fire, electric shock, or malfunction. Be careful to avoid exposure to moisture or dirt.
- If you are not going to use the microphone or receiver for an extended period, charge it once every 6 months to prevent the deterioration of the built-in rechargeable battery.
- When charging the microphone or receiver via a speaker, be sure to connect or disconnect the USB cable while the speaker is turned off.

Related Topic

- [Parts and controls](#)
- [Notes on charging](#)

5-066-054-11(1) Copyright 2025 Sony Corporation

Wireless Microphone
UO-ULTMIC1

Automatic Power Off (power saving) function

In the following cases, the power of the microphone and receiver will be automatically turned off to conserve the built-in rechargeable battery.

Microphone

- 5 minutes have passed while waiting for a connection with the receiver.
- 5 minutes have passed in pairing mode.
- 5 minutes have passed with no audio input or handling while the microphone is connected to the receiver.
- The built-in rechargeable battery is fully discharged.

Receiver

- 5 minutes have passed while waiting for a connection with the microphone.
- 5 minutes have passed in pairing mode.
- The built-in rechargeable battery is fully discharged.

Wireless Microphone
UO-ULTMIC1

Using the microphone with a speaker

Connect the receiver and microphone, and output the audio from the speaker.

The following speakers have been confirmed to be compatible with the microphone and receiver. (*1) (*2)

- Speakers in the ULT POWER SOUND series that are equipped with a microphone jack (Φ 6.3 mm).
- SRS-XV900, SRS-XV800, SRS-XV500, SRS-XP700, SRS-XP500 (*3)

(*1) Depending on the orientation of the receiver and the shape of the speaker, the receiver may interfere with buttons or other parts of the speaker.

(*2) Some models may not be available for sale in some countries or regions.

(*3) These speakers do not support the use of multiple receivers.

Hint

- You can connect up to 2 microphones to each receiver.

Note

- Be sure to turn off the speaker before connecting or disconnecting the receiver.

1 Connect the receiver's standard plug to the microphone jack on the speaker.

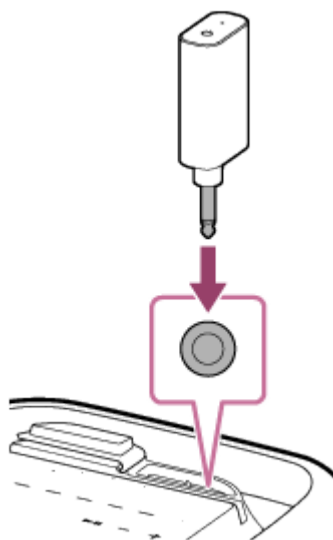

Note

- Depending on the orientation of the receiver and the shape of the speaker, the receiver may interfere with buttons or other parts of the speaker.

2 Turn on the speaker.

3 Turn on the microphone and receiver.

- Press the power button on the microphone.

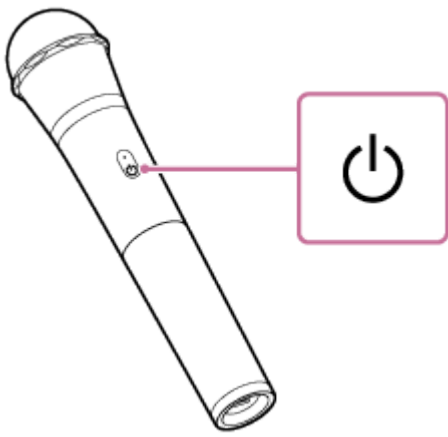

- Press and hold the power button on the receiver for about 2 seconds.

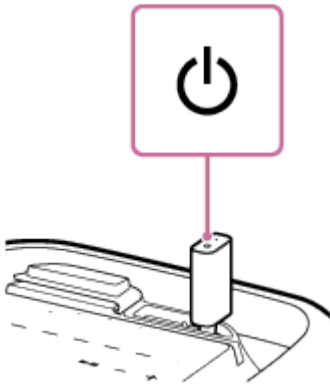

When both the microphone and receiver are turned on, both power indicators will flash slowly in white. Once the connection is complete, the power indicators will switch from flashing to lit. (*)

(*) The color and flashing pattern of the indicators may vary depending on the remaining built-in battery power. For details, see [“About the indicators.”](#)

4 Use the speaker to adjust the microphone volume.

5 Talk or sing into the microphone.

After use

Turn off the microphone and receiver.

You can turn them off in the same way as when you turned them on.

Once the power is off, the power indicators on both the microphone and receiver will turn off.

Note

- If you move the microphone closer to the speaker, acoustic feedback may occur. When this happens, depending on the volume of the speaker, the speaker may automatically turn off due to the product protection function. In this case, wait for a while before turning the speaker back on.
- The microphone and receiver are not designed to be waterproof or dustproof. Depending on how they are used, water or dust may get inside, potentially causing fire, electric shock, or malfunction. Be careful to avoid exposure to moisture or dirt.

Related Topic

- [Parts and controls](#)
- [About the Duet Assist function](#)

Wireless Microphone
UO-ULTMIC1

About the Duet Assist function

The Duet Assist function allows you to automatically adjust the volume of each microphone to an appropriate balance when using 2 microphones.

The Duet Assist function is enabled at the time of purchase.

To enable or disable the Duet Assist function

1 Turn on the receiver.

Press and hold the power button on the receiver for about 2 seconds.

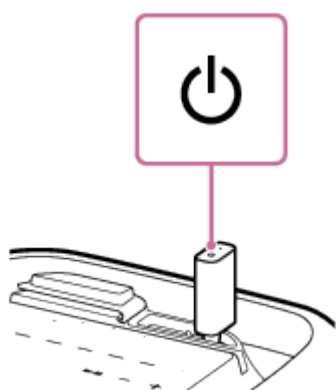

2 Press the power button on the receiver 3 times quickly.

- When the Duet Assist function is disabled, the power indicator on the receiver flashes 3 times in white (*).
- When the Duet Assist function is enabled, the power indicator on the receiver flashes twice in white (*).

(*) If the remaining built-in battery power is low, the power indicator flashes in orange. For more details, see [“About the indicators.”](#)

Hint

- The setting is retained on the receiver even when the receiver is turned off.

Related Topic

- [Parts and controls](#)

Wireless Microphone
UO-ULTMIC1

About the indicators

Charge indicator (orange)

Depending on the charging status of the microphone or receiver, the indicator will light up or turn off as follows.

Unlit	Battery charging is complete.
Lit	Battery charging is in progress.

Note

- The microphone or receiver can be charged even if the power is on, as long as it is connected to a power outlet using a USB AC adaptor. However, depending on usage conditions, charging time may be longer. For optimal charging, it is recommended to turn off the microphone or receiver.
- Depending on the types or specifications of the USB AC adaptor, the remaining power of the built-in rechargeable battery may decrease or the power may turn off even when the microphone or receiver is connected to a power outlet. This is not a malfunction. In such cases, turn off the power and fully charge the microphone or receiver before use.
- Charging will stop in environments with extremely high or low temperatures for safety reasons. Additionally, charging may stop if it continues for an extended period. To resume charging, disconnect and reconnect the USB cable within the usable temperature range of 5 °C to 35 °C (41 °F to 95 °F).

power indicator

The indicator will light up in white when the remaining built-in battery power of the microphone or receiver is more than 21%.

The indicator will light up in orange when the remaining built-in battery power of the microphone or receiver is 20% or below.

● Microphone

Unlit	The microphone is turned off.
Lit	The microphone is connected to the receiver, and its remaining built-in battery power is more than 21%.
Double flashing	The microphone is in pairing mode with the receiver.
Flashing	<ul style="list-style-type: none"> ● The indicator will continue to flash slowly when the microphone is in connection standby mode with the receiver. ● The indicator will continue to flash in orange at a slower interval than in the connection standby mode when the microphone is connected to the receiver and its remaining built-in battery power is 20% or below.
Fast flashing (*)	An abnormality in the internal temperature or the built-in rechargeable battery has been detected. Disconnect the USB cable, wait for a while, and then restart the microphone. For more details, see "Notes on charging."

(*) The remaining built-in battery power does not affect the indicator's color, and it flashes orange.

● Receiver

Unlit	The receiver is turned off.
Lit	The receiver is connected to the microphone, and its remaining built-in battery power is more than 21%.
Double flashing	The receiver is in pairing mode with the microphone.
Flashing	<ul style="list-style-type: none">● The indicator will continue to flash slowly when the receiver is in connection standby mode with the microphone.● The indicator will continue to flash in orange at a slower interval than in the connection standby mode when the receiver is connected to the microphone and its remaining built-in battery power is 20% or below.● Press the power button on the receiver 3 times quickly. The indicator flashes twice when the Duet Assist function is enabled.● Press the power button on the receiver 3 times quickly. The indicator flashes 3 times when the Duet Assist function is disabled.
Fast flashing (*)	An abnormality in the internal temperature or the built-in rechargeable battery has been detected. Disconnect the USB cable, wait for a while, and then restart the receiver. For more details, see “Notes on charging.”

(*) The remaining built-in battery power does not affect the indicator's color, and it flashes orange.

Related Topic

- [Parts and controls](#)

Wireless Microphone
UO-ULTMIC1

Precautions

On safety

- Refer to the supplied Reference Guide.
- The nameplate and important information concerning safety are attached in the following locations:
 - Microphone: the unit side, inside the cover at the bottom of the unit
 - Receiver: the back of the unit

On placement

- To eliminate the risk of malfunctions, avoid the following locations when placing or leaving this unit.
 - A place subject to high temperatures, such as under direct sunlight or lighting equipment, near a heat source, or in a sauna
 - Inside a vehicle with the windows closed (especially in summertime)
 - A place exposed to hot air, such as from a hair dryer
 - A place subject to excessive dust
 - A place subject to strong vibration
- Do not splash water onto the microphone or receiver. They are not designed to be waterproof.
- Make sure that dust and sand do not adhere to the microphone or receiver. They are not designed to be dustproof.
- The microphone passes the drop test from 1.22 m (4 ft) on plywood of 5 cm (2 in) thickness conforming to MIL-STD810H Method 516.8-Shock. However, this does not guarantee no damage or no breakdown in all conditions. Deformation or damage from dropping the unit or subjecting it to mechanical shock may cause deterioration of the performance.

Other notes

- Charging will stop in environments with extremely high or low temperatures for safety reasons. Additionally, charging may stop if it continues for an extended period. To resume charging, disconnect and reconnect the USB cable within the usable temperature range of 5 °C to 35 °C (41 °F to 95 °F).
- If you are not going to use the microphone or receiver for an extended period, charge it once every 6 months to prevent the deterioration of the built-in rechargeable battery.
- The temperature of the microphone and receiver may rise during charging or prolonged use. However, this is not a malfunction.
- Depending on the communication environment between the microphone and receiver and the surrounding conditions, noise or audio interruptions may occur during use.

- If you have any questions or problems concerning this microphone or receiver that are not covered in this manual, please consult Sony support contact or your nearest Sony dealer.

5-066-054-11(1) Copyright 2025 Sony Corporation

Wireless Microphone
UO-ULTMIC1

To prevent burning or malfunction caused by exposure to water

The microphone and receiver are not designed to be waterproof. Depending on how they are used, water may get inside, potentially causing fire, electric shock, or malfunction.

Note that malfunctions caused by water damage due to improper handling are not covered by the warranty. Avoid the following situations and take care to keep the microphone and receiver free from moisture and dirt.

- Place the microphone or receiver in an area exposed to rain.

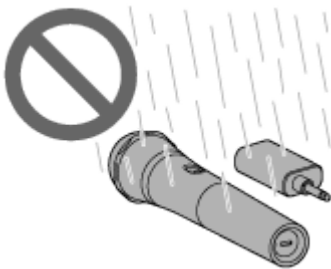

- Handle the microphone or receiver with wet hands without thoroughly drying them.



- Accidentally spill a drink on the microphone or receiver while eating or drinking.

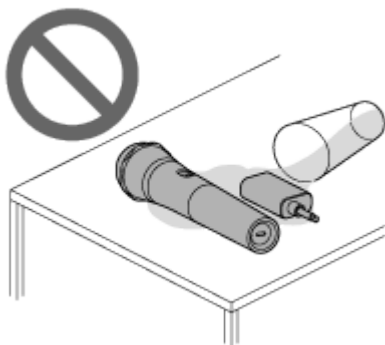

- Wash the microphone or receiver with water.



If the microphone or receiver gets wet or dirty, see [“In case of water exposure”](#) and clean them as described before use.

5-066-054-11(1) Copyright 2025 Sony Corporation

Wireless Microphone
UO-ULTMIC1

In case of water exposure

The microphone and receiver are not designed to be waterproof. Depending on how they are used, water may get inside, potentially causing fire, electric shock, or malfunction. Review the following points and use the product correctly.

To maintain performance

- Do not insert the USB plug while the microphone, receiver, or USB cable is wet.
 - Do not splash water onto the microphone or receiver.
 - Do not drop the microphone or receiver into water or use them underwater.
 - Do not use the microphone or receiver in places with high humidity, such as bathrooms.
 - Do not drop or subject the microphone or receiver to impact. Deformation or damage may cause deterioration in performance.
 - If water splashes onto the microphone or receiver, hold the USB port facing down and shake it 2 or 3 times to remove any water droplets. Then, immediately wipe the port with a dry, soft cloth and leave it at room temperature to dry.
 - If the microphone or receiver is wet when you charge it, it may cause corrosion of the port. Before charging, thoroughly wipe off any moisture with a dry, soft cloth, and leave it at room temperature to dry.
- Note that malfunctions caused by water damage due to improper handling are not covered by the warranty.

— Microphone

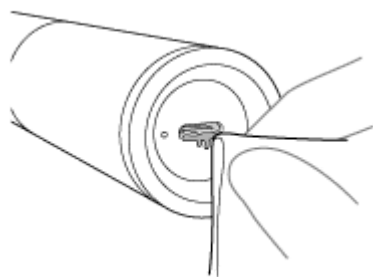

— Receiver

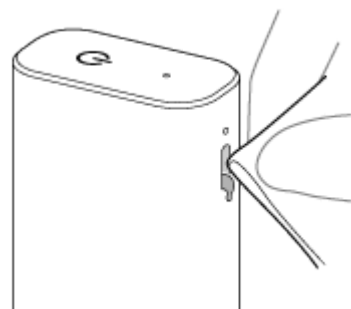

- If the port of the microphone or receiver become dirty, clean it with a dry, soft cloth.
- If cracks or deformation are observed, avoid using the microphone or receiver in places where it may get wet, consult Sony support contact or your nearest Sony dealer.

Wireless Microphone
UO-ULTMIC1

Notes on charging

About the lifespan of the built-in lithium-ion rechargeable battery

- If you are not going to use the microphone or receiver for an extended period, charge it once every 6 months to prevent the deterioration of the built-in rechargeable battery.
- If the microphone or receiver has not been used for an extended period, it may take longer to charge the built-in rechargeable battery.
- The built-in rechargeable battery has a limited lifespan. With repeated use and over time, the battery capacity gradually decreases. If you feel that the usage time becomes extremely short even after a full charge, consult Sony support contact or your nearest Sony dealer.
- If the usage time becomes extremely short, the built-in rechargeable battery may have reached the end of its lifespan.
- The lifespan of the built-in rechargeable battery varies depending on storage conditions, usage, and the environment.

Caution

If an abnormality in the internal temperature or the built-in rechargeable battery is detected, the power indicator on the microphone and receiver will flash in orange quickly.

- Microphone

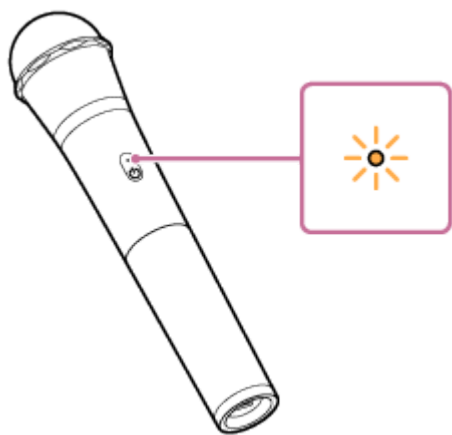

- Receiver

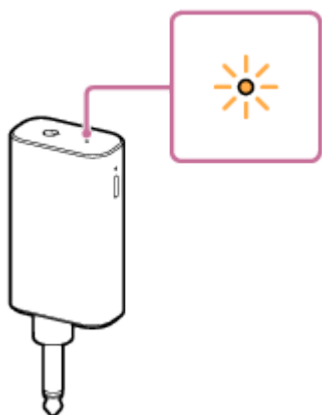

If an abnormality is detected, disconnect the USB cable and wait for a while. Then, press and hold the power button on the microphone or receiver for about 10 seconds to restart it. If the issue persists, consult Sony support contact or your nearest Sony dealer.

Note

- The microphone and receiver are not designed to be waterproof or dustproof. Depending on how they are used, water or dust may get inside, potentially causing fire, electric shock, or malfunction. Be careful to avoid exposure to moisture or dirt.
- Charging time varies depending on the usage conditions of the built-in rechargeable battery.
- Charge the microphone or receiver in an ambient temperature between 5 °C and 35 °C (41 °F and 95 °F). Be aware that room temperatures may fall to 5 °C (41 °F) or lower depending on the season, especially during winter.
- The microphone and receiver may become warm during charging. However, this is not a malfunction.
- Avoid sudden temperature changes, direct sunlight, mist, sand, dust, and electrical shocks. Also, never leave the microphone and receiver inside a parked car.
- The microphone or receiver can be charged even if the power is on, as long as it is connected to a power outlet using a USB AC adaptor. However, depending on usage conditions, charging time may be longer. For optimal charging, it is recommended to turn off the microphone or receiver.
- Charging will stop in environments with extremely high or low temperatures for safety reasons. Additionally, charging may stop if it continues for an extended period. To resume charging, disconnect and reconnect the USB cable within the usable temperature range of 5 °C to 35 °C (41 °F to 95 °F).
- If the built-in rechargeable battery experiences a high load during charging, charging will stop for safety reasons. In such cases, stop using the microphone or receiver.
- The functionality of USB ports extended via a USB hub is not guaranteed. Only self-powered USB hubs with logo certification are guaranteed to work.

Related Topic

- [Parts and controls](#)
- [Charging the microphone and receiver](#)
- [Restart the microphone or receiver](#)

Wireless Microphone
UO-ULTMIC1

How to care for the microphone and receiver

You can use the microphone and receiver more comfortably and for a longer period of time by following the maintenance procedure below.

- When the surface becomes dirty, wipe it with a dry, soft cloth or a cloth soaked in water or lukewarm water and wrung out firmly. Depending on the type of dirt, it may not come off.

Note

- Do not use neutral detergents, thinners, benzine, or similar substances when cleaning the surface. Such substances may cause discoloration or deterioration of the microphone and receiver surfaces.
If you use a disinfectant wipe, use one with an alcohol concentration of 60% or less. After wiping, be sure to finish off with a dry, soft cloth.

Wireless Microphone
UO-ULTMIC1

Licenses

- Services offered by third parties may be changed, suspended, or terminated without prior notice. Sony does not bear any responsibility in these sorts of situations.

Wireless Microphone
UO-ULTMIC1

Trademarks

- USB Type-C® and USB-C® are registered trademarks of USB Implementers Forum.

All other trademarks and registered trademarks are trademarks or registered trademarks of their respective holders. In this manual, ™ and ® marks are not specified.

Wireless Microphone
UO-ULTMIC1

Troubleshooting

When you encounter any issues, follow the steps below.

1. Charge the microphone or receiver.



2. Restart the speaker you are using.



3. Restart the microphone or receiver.



4. Should any problems persist, consult Sony support contact below or your nearest Sony dealer.

<https://www.sony.net/support-contact>

Note

- If repairs are necessary, bring the microphones, receiver, and all cables together to Sony support contact or your nearest Sony dealer.

Related Topic

- [Charging the microphone and receiver](#)
- [Restart the microphone or receiver](#)

Wireless Microphone
UO-ULTMIC1

Pair the microphone and receiver again

At the time of purchase, the microphone and receiver are already paired. When you turn on both the microphone and receiver, they will automatically connect.

If the microphone and receiver do not connect and both power indicators continue to flash in white (*) after turning on them, pair the microphone and receiver again.

(*) If the remaining built-in battery power is low, the power indicator flashes in orange. For more details, see ["About the indicators."](#)

1 Press and hold the power button on the microphone and receiver simultaneously for about 5 seconds.

The microphone and receiver enter pairing mode, and both power indicators start double flashing in white. Once connected, the indicators will change from flashing in white to lit in white. (*)

(*) The color and flashing pattern of the indicators may vary depending on the remaining built-in battery power. For details, see ["About the indicators."](#)

● Microphone

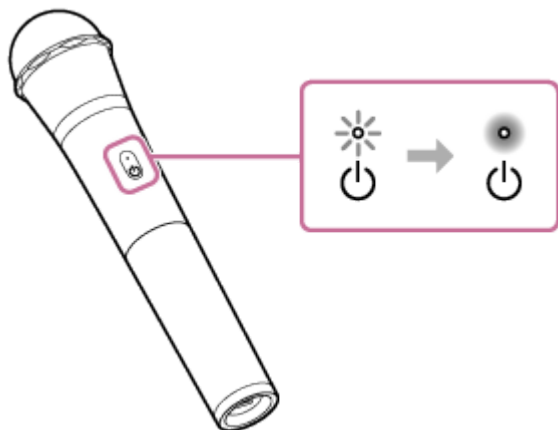

● Receiver

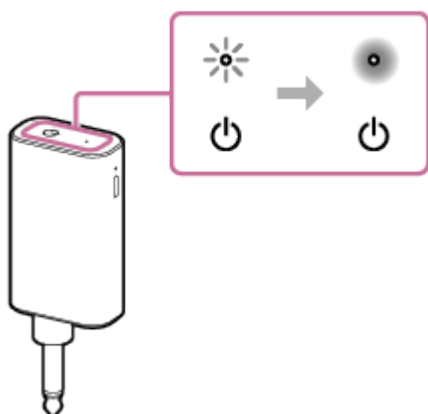

Hint

- You can connect up to 2 microphones to each receiver.
- Each microphone is paired with a receiver. If you need to pair 2 microphones with the receiver again, follow the above steps for each microphone individually.

Related Topic

- [Parts and controls](#)

5-066-054-11(1) Copyright 2025 Sony Corporation

Wireless Microphone
UO-ULTMIC1

There is acoustic feedback

- Use the speaker to lower the microphone volume.
- Move the microphone away from the speaker or change the direction of the microphone.

Note

- If you move the microphone closer to the speaker, acoustic feedback may occur. When this happens, depending on the volume of the speaker, the speaker may automatically turn off due to the product protection function. In this case, wait for a while before turning the speaker back on.

Wireless Microphone
UO-ULTMIC1

Restart the microphone or receiver

In the following situations, press and hold the power button on the microphone or receiver for about 10 seconds to restart the microphone or receiver.

- The microphone or receiver does not function properly even after turning it on.
- The microphone or receiver does not function properly even after resolving the pairing issues.

While pressing the power button, the microphone or receiver remains turned off. After about 10 seconds, release the power button to turn the power back on and complete the restart.

- Microphone

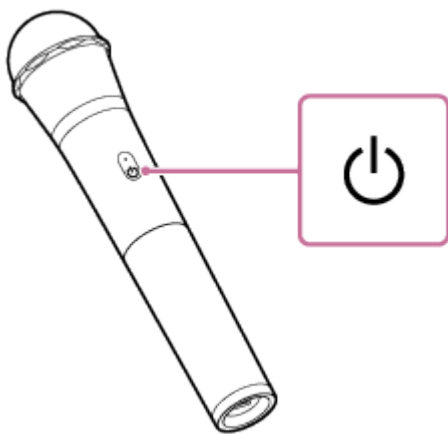

- Receiver

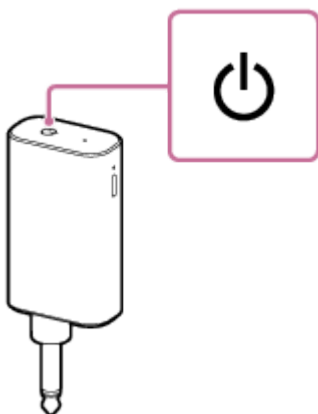

Note

- Pairing information and connection history will not be deleted even if you restart the microphone or receiver.

Related Topic

- [Parts and controls](#)

Wireless Microphone
UO-ULTMIC1

Specifications

Microphone (transmitter)

Communication specification

Frequency band

2.4 GHz band (2.400 0 GHz - 2.483 5 GHz)

Operating frequency / Maximum output power

2 400 MHz - 2 483.5 MHz / < 10.0 dBm

Microphone

Type

Dynamic

Directivity

Uni directional

Effective frequency range

50 Hz - 15 000 Hz

General

Power

DC 5 V 0.5 A (using a commercially-available USB AC adaptor capable of feeding in 0.5 A (500 mA)) or, using built-in lithium-ion battery

Power consumption (*)

Approximately 2.5 W

(*) When used with a USB AC adaptor that outputs a current of 0.5 A (500 mA) or more

Standby power consumption

Approximately 0.3 W

Operating temperatures

5 °C - 35 °C (41 °F - 95 °F)

Dimensions (W × H × D)

Including projecting parts and controls

Approximately 51 mm × 233 mm × 51 mm (2.0 in × 9.2 in × 2.0 in)

Mass (Including battery)

Approximately 280 g (10 oz)

Receiver

Communication specification

Frequency band

2.4 GHz band (2.400 0 GHz - 2.483 5 GHz)

General

Power

DC 5 V 0.5 A (using a commercially-available USB AC adaptor capable of feeding in 0.5 A (500 mA)) or, using built-in lithium-ion battery

Power consumption (*)

Approximately 2.5 W

(*) When used with a USB AC adaptor that outputs a current of 0.5 A (500 mA) or more

Standby power consumption

Approximately 0.3 W

Operating temperatures

5 °C - 35 °C (41 °F - 95 °F)

Dimensions (W × H × D)

Including projecting parts and controls

Approximately 42 mm × 115 mm × 23 mm (1.7 in × 4.6 in × 0.9 in)

Mass (Including battery)

Approximately 65 g (3 oz)

Hint

- For information on the charging time and battery hours of the built-in rechargeable battery, see “[Charging the microphone and receiver.](#)”

Note

- Design and specifications are subject to change without notice.
- Refer to the supplied Reference Guide, which may contain specification information not listed above.